

ICE MASTER® T-SERIES

OWNER'S MANUAL



Product Codes:

IMT250E	IMT300E	IMT500E	IMT800E	IMT995E
IMT250ESC	IMT300ESC	IMT500ESC	IMT800ESC	IMT995ESC
IMT250G	IMT300G	IMT500G	IMT800G	IMT995G
IMT250GSC	IMT300GSC	IMT500GSC	IMT800GSC	IMT995GSC

Version 1.9

Copyright © Enduraplas. All Rights Reserved.



CONTENTS

INTRODUCTION	3
<hr/>	
WARNINGS 	4 & 5
<hr/>	
GETTING STARTED	6 - 15
<hr/>	
CALIBRATING	16 & 17
<hr/>	
MAINTAINING	18 & 19
<hr/>	
TROUBLESHOOTING	20 & 21
<hr/>	
PARTS BREAKDOWNS - ICE MASTER® T-SERIES	22 - 81
<hr/>	
WARRANTY	82 - 84
<hr/>	

INTRODUCTION

Congratulations! You now own a Camion™ sprayer. Durable design and construction assure you a lifetime of extreme performance. No sprayer is tougher. No sprayer will last longer.

Take a look through this owner's manual to learn how the pros use their Camion™ sprayer.



Watch Instruction Videos:

www.youtube.com

Discover More Helpful Tips:

www.IceControlTraining.com

WARNINGS

1. Do not exceed vehicle manufacturers loading, towing or lifting specifications and regulations.
2. Ensure tank is firmly secured in an appropriate manner.
3. Use caution at all times, particularly when driving on rough terrain.
4. Comply with chemical manufacturers safety requirements and all relevant legislations.
5. ALWAYS keep tank tightly covered, to prevent children or animals from entering tank.
6. Tank is not fire resistant. NEVER expose it to open flame or heat.
7. Keep sharp objects from tank. Tank could be punctured and contents could escape and cause injury to persons or property.
8. This tank can be used only with polyethylene compatible liquids. If you are uncertain, ask chemical supplier if material can safely be stored in a polyethylene tank.
USE OF TANK WITH ANY OTHER MATERIAL COULD CAUSE TANK TO FAIL, RESULTING IN INJURY OR PROPERTY DAMAGE.
9. DO NOT MIX CHEMICALS. THIS CAN RESULT IN DAMAGE TO THE TANK OR NEARBY PERSONS OR PROPERTY.
10. Clean out tank before changing chemicals OTHERWISE A DANGEROUS MIXTURE OF CHEMICALS COULD CAUSE DAMAGE TO PERSONS, TANK OR PROPERTY.
11. Regular service and maintenance is the Owner's responsibility and is a condition of your warranty.
12. FAILURE TO COMPLY WITH ALL WARNINGS AND INSTALLATION INSTRUCTIONS WILL VOID WARRANTY.

13. No modifications and/or alterations may be made to this sprayer. Any such modifications not only void the sprayer warranty but can make the unit dangerous to anyone operating the pump.
14. Always inspect hoses and piping to avoid burst injuries.
15. DO NOT turn suction valve off while pump is running.
NEVER RUN PUMP DRY.

COMPATIBLE LIQUIDS

Calcium Chloride Brine, Salt Brine and Premium Branded Liquids.

⚠ Caution: Brine that contain tacky substances or solid particles may clog pumps and nozzles. These are not recommended.

⚠ Warning: DO NOT USE any products that contain petroleum or petroleum by-products of any kind. These destroy seals and will void warranty.

Discover More Helpful Tips:
www.IceControlTraining.com

GETTING STARTED

Setting Up Your Sprayer

1) The two openings at the front of the frame allow you to move the unit using fork points.

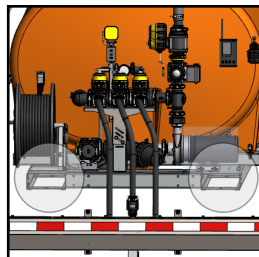

2) When loading your sprayer, we recommend you place blocking between your sprayer and the front of the bed of your truck.

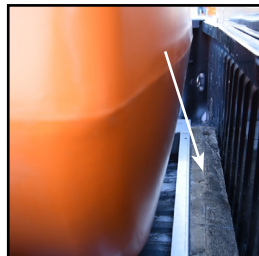

3) On the Ice Master® T-Series, there are tie-down points on the side of the frame that allow you to strap the unit down.

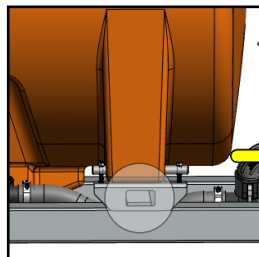

4) Screw the hose reel handle into place.

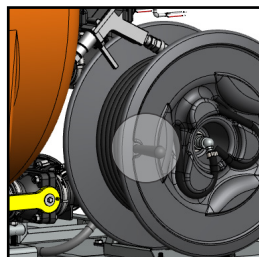

GETTING STARTED

Setting Up Your Sprayer

5) Insert the receiver bracket into the truck receiver hitch and secure with lock pin.

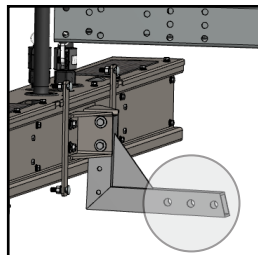

6) Take the three hoses from the boom and connect them to the control valves using the camlock system.

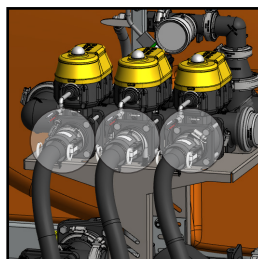

7) If you purchased a unit with our high flow electric Ecomax® pump option, you will need to hook up the ring terminals on the wire harness to your battery and route the wire harness back to the electric motor.

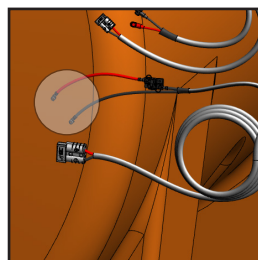

8) Plug in the gray connector from wire harness to the matching gray connector on wire harness coming off motor.

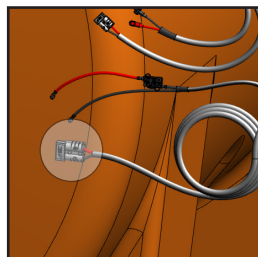

GETTING STARTED

Setting Up Your Sprayer

9) If you purchased a hydraulic unit, hook up your desired hydraulic hoses to the side ports on the hydraulic pump. This pump requires 13 GPM oil flow.

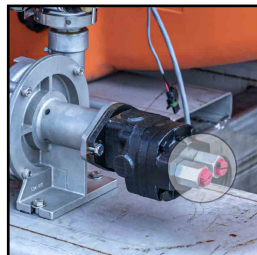

10) If you have a gas powered unit, fill the fuel tank on the engine with regular gasoline.



11) If you have a gas powered unit you will also need to remove the oil cap and fill the engine with 0.61 US quarts of 10W-30 engine oil.



12) If you have a gas powered unit, you will need to install a battery into the provided battery box and connect your positive and negative cables to the correct terminals.

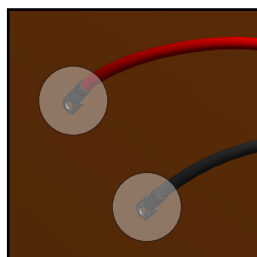

GETTING STARTED

Hooking Up Standard Controls

1) If your applicator does not have a GPS flow control option, you will need to connect the standard control wire harness to the 3 electric valves that will control your left, center, and right boom sections.

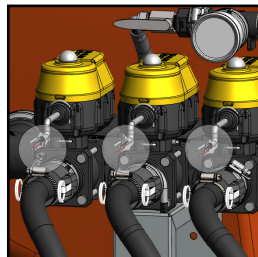

2) Then, connect the in cab control box to the 12V power outlet in your cab.

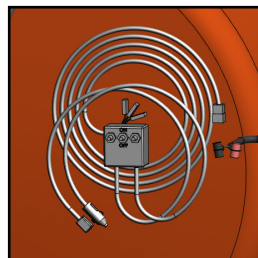

GETTING STARTED

Hooking Up GPS Flow Control

1) Hook up Storm Commander® control box arm to back of controller and install controller mount into the cupholder of the vehicle cab.



2) Plug in your 12v outlet plug in vehicle cab to power up your Storm Commander®.



3) To power up the receiver box at the back of unit, plug the power cable into the 7 pin plug on back of truck.



Refer to the Storm Commander® wireless controller
“Getting Started” instructions.

GETTING STARTED

Operating Your Sprayer

1) You will need to prime the pump before using it. Start by filling the tank at least a quarter full of water.

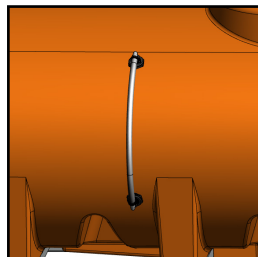

2) Then open the suction valve between the tank and the pump.

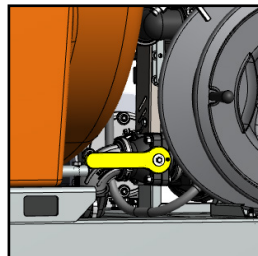

3) Place the 3-way valve in recirculation position to allow liquid to recirculate back to the tank. If your applicator is GPS flow controlled, you will need to manually open the electric flow control valve using your Storm Commander® controller (refer to your Storm Commander® “Operating” instructions).

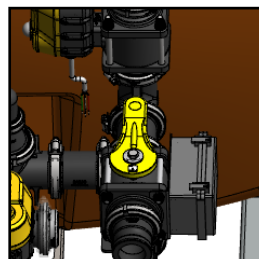
**Important Tip:**

If you have the unit with the hydraulic pump, it will prime automatically.

GETTING STARTED

Operating Your Sprayer

4) If your applicator has the gas engine driven pump, open the top cap of the pump, and fill the pump with water. Before starting the engine make sure both the drain plug and prime plug are tightened securely to properly hold the sealing O-rings in place.

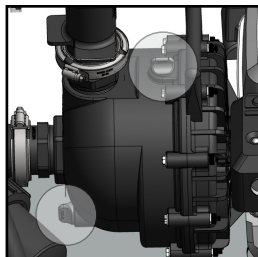

5) If your applicator has the gas engine driven pump, start the engine, and increase the RPM's, and check that water is recirculating back to the tank. Your pump should now be primed.

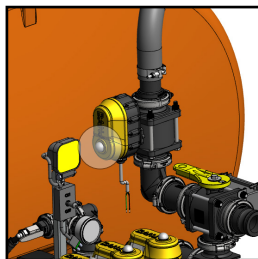

6) If your applicator has the high flow electric Ecomax® pump, power it on and close the 3-way valve on top of your pump for approximately 20 secs to build pressure. Then slowly re-open the valve and the pump should prime. If it does not prime, check that your tank is at least 1/4 full and repeat this step.

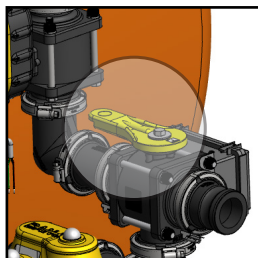

7) Once the pump is primed, make sure your 3-way valve is in the correct operating position.

- a. GPS flow controlled - open position (picture shown in recirculation position).
- b. Non-GPS - closed position.

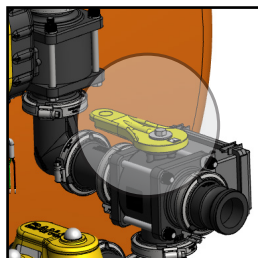

GETTING STARTED

Operating Your Sprayer

8) To fill the applicator, close the suction valve between the tank and the pump (picture shown in open position).

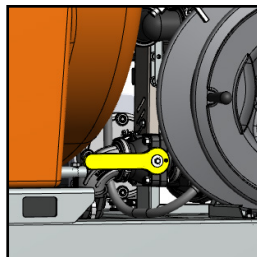

9) Make sure the 3-way valve on top of pump is in recirculation position, then connect storage source hose to your applicator and open the external fill valve.

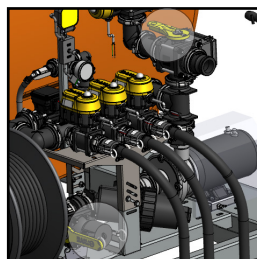
**Important Tip:**

When filling from an external source with an electric pump, make sure the liquid level in your storage reservoir is level to (or higher than) your pump.

10) If your applicator has the Storm Commander® GPS flow control option, you will need to open the electric flow control valve from your in-cab controller. (Ref. the Storm Commander® “Getting Started” instructions.)

GETTING STARTED

Operating Hand Gun

1) To use the spray gun, ensure the 3-way valve on top of pump is in closed position and hose reel shutoff valve is in the open position (3-way valve shown in recirculation position).

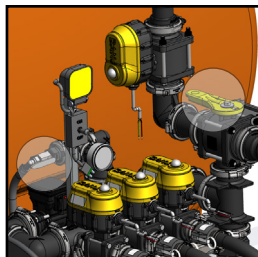

Important Tip:

If you are using your hand wand for extended periods of time, it is best to leave the 3-way valve, on top of pump, slightly open to allow liquid to recirculate through the pump even when the hand gun is not in use.

Pumping Liquid out of Applicator

1) To drain your tank using the pump on the applicator, hook up hose from storage to the discharge port on the top of your pump and open the suction valve.

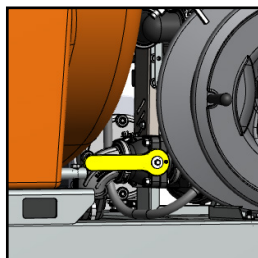

2) Power applicator pump on and move the 3-way valve on top of pump in the discharge position (picture shown in recirculation position).

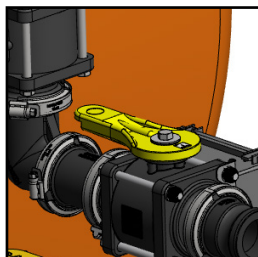

GETTING STARTED

Operating Your Sprayer

14) If you purchased the optional storage stand, you can attach the legs with the supplied pins.



15) If you purchased the optional self-loading leg stand, adjust legs to desired height.

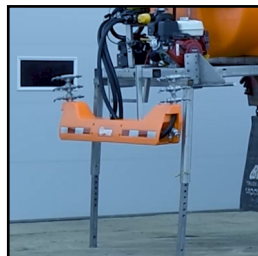

CALIBRATING

Note: Always double check your application rates.
The rate/acre listed is only based off the center section
(not the two side nozzles)

NOZZLE COLOR	PSI	CAPACITY ONE NOZZLE IN GPM				4 MPH	6 MPH	8 MPH	10 MPH
		0.75	1.06	1.30	1.50				
Stainless Steel	10	0.75	1.06	1.30	1.50	74	49	37	29
	20	1.06	1.30	1.50	1.73	105	70	52	42
	30	1.30	1.50	1.73	2.00	129	86	64	51
	40	1.50	1.73	2.00	2.22	148	99	74	59
Black	15	1.22	1.41	1.73	2.00	90	60	45	36
	20	1.41	1.73	2.00	2.22	105	70	52	42
	30	1.73	2.00	2.22	2.44	128	86	64	51
	40	2.00	2.22	2.44	2.66	148	99	74	59

GPM = Gallons Per Minute

GPA = Gallons Per Acre

GAL/1000 FT = Gallons Per 1000 Square Feet

W = Nozzle spacing

Gallons Per Minute Formula:

$$\frac{\text{GPA} \times \text{MPH} \times \text{W (per nozzle)}}{5,940}$$

Gallons Per Minute Formula:

$$\frac{\text{GAL/1000FT} \times \text{MPH} \times \text{W (per nozzle)}}{136}$$

Gallons Per Acre Formula:

$$\frac{5,940 \times \text{GPM (per nozzle)}}{\text{MPH} \times \text{W}}$$

Gallons Per 1000 Square Feet:

$$\frac{136 \times \text{GPM (per nozzle)}}{\text{MPH} \times \text{W}}$$

Convert Acres to Lane Mile:

$$1.4545 = 1 \text{ Lane Mile}$$

Note: For video instructions on how to calibrate a boom visit
<http://bit.ly/IMS-boom-calibration>

MAINTAINING

Keeping your sprayer in good condition will help you lengthen the life of the sprayer. Everyone knows a well maintained piece of equipment ensures a longer life span. Sprayer maintenance can seem a huge task if you don't have the right tools.



Watch Instruction Videos:

www.youtube.com

Discover More Helpful Tips:

www.IceControlTraining.com

The information applies in normal operating conditions. The specific intervals must be shortened accordingly for longer daily working hours. If the machine is only used occasionally, the intervals can be extended accordingly.		Visual inspection (condition, leaks)	Before starting work	At the end of work and/or daily	Weekly or every 40 operating hours	After the first 5 operating hours	Every 250 operating hours or once a year	If damaged	If required	
		Clean	X	X						
		Clean		X						
		Drain		X						
		Clean		X						X
		Clean								X
		Replace							X	
All accessible screws and nuts	Retighten								X	
	Replace							X		
Safety labels										
Pump	Maintain							X		
Read and follow all maintenance and care instructions in the Pump manual.										

TROUBLESHOOTING

CONDITION	CAUSE	REMEDY
Pump will not prime	1) Air leak on suction plumbing 2) Blocked/Restricted intake hose 3) Filter cap disengaged 3) Filter gasket damaged/missing	1) Tighten/replace fittings & hose clamps. Verify suction hoses are in good condition 2) Remove blockage from suction line, ensure line is not kinked 3) Lock filter cap into position 4) Replace filter gasket
Pressure drops/ fluctuates during standard operation	1) Restriction on suction line 2) Pump sucking air 3) Plugged filter 4) Damaged regulator	1) Inspect tank and suction lines and remove restriction 2) Tighten fittings 3) Remove and clean filter mesh and housing 4) Remove regulator stem and inspect for broken parts/pieces

CONDITION	CAUSE	REMEDY
Pressure gauge not registering	1) Plugged with debris	1) Un-thread, check and clean pressure gauge
Hand gun loses pressure	1) Debris in hose or nozzle 2) Pump losing prime 3) Pump pressure dropping/fluctuating	1) Un-thread nozzle tip and clean 2) See Remedy for 'Pump will not prime or loses prime' 3) See Remedy for 'Pressure drops/ fluctuates during standard operation'



Watch Instruction Videos:

www.youtube.com

Discover More Helpful Tips:

www.IceControlTraining.com

PARTS BREAKDOWN CONTENTS

ECOMAX® NON-GPS	23 - 32
-----------------	---------

ECOMAX® GPS	33 - 38
-------------	---------

GAS NON-GPS	39 - 44
-------------	---------

GAS GPS	45 - 50
---------	---------

HYDRAULIC GPS	51 - 56
---------------	---------

HYDRAULIC NON-GPS	57 - 62
-------------------	---------

12 NOZZLE BOOM	63 & 64
----------------	---------

22 NOZZLE BOOM	65 & 66
----------------	---------

DEICING HOSE REEL	67
-------------------	----

LIGHT KIT	68
-----------	----

ADJUSTABLE RECEIVER HITCH	69
---------------------------	----

OPTIONS	70 - 79
---------	---------

STORM COMMANDER HARNESS COMPONENTS	80 - 81
---------------------------------------	---------

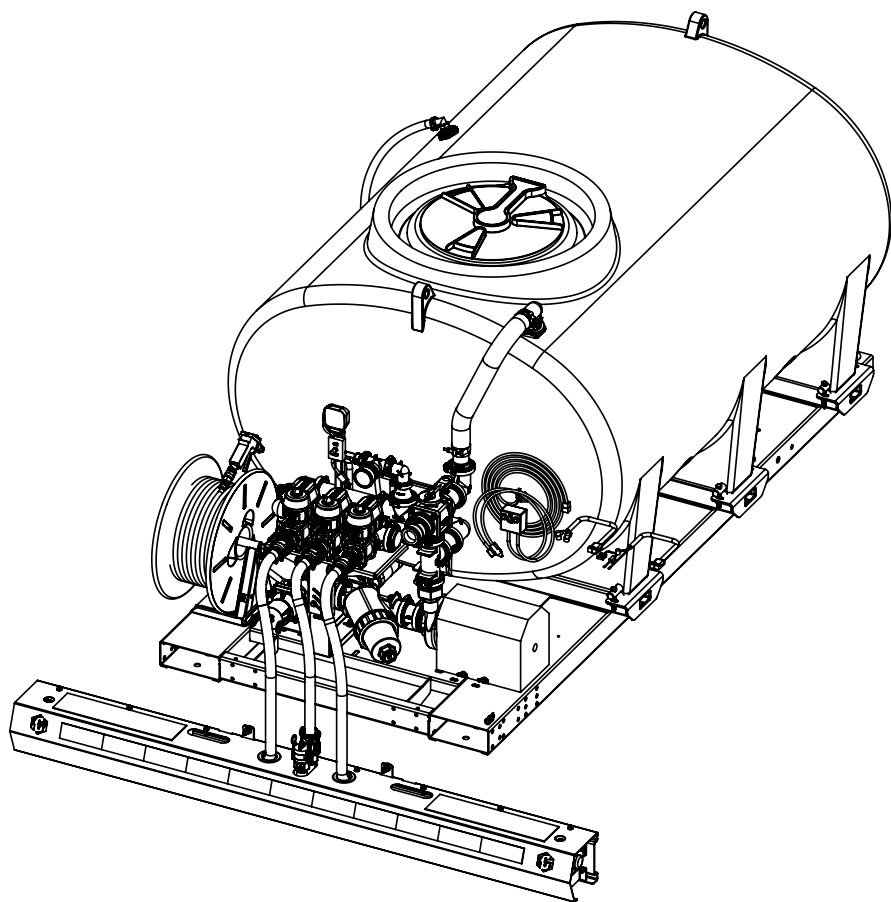

IMT500-ECOMAX NON GPS 2023

OVERVIEW

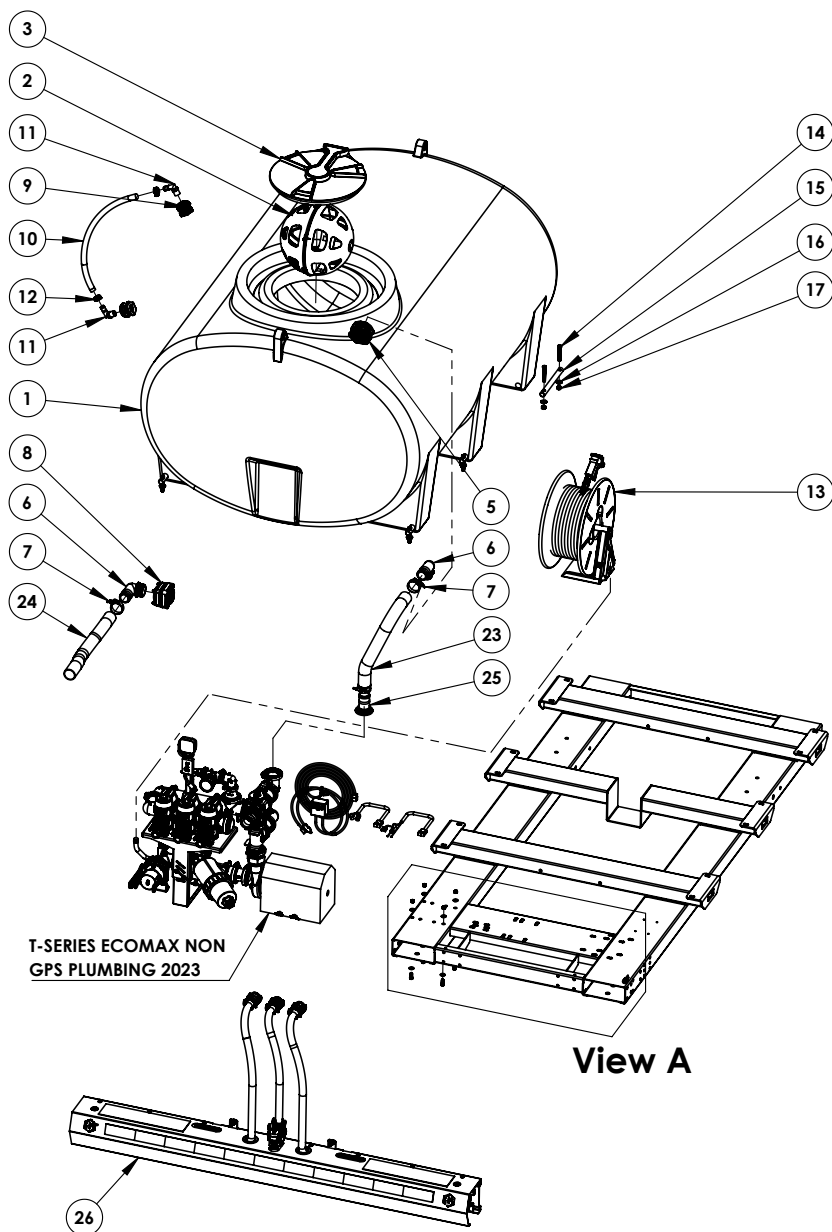

VIEW A

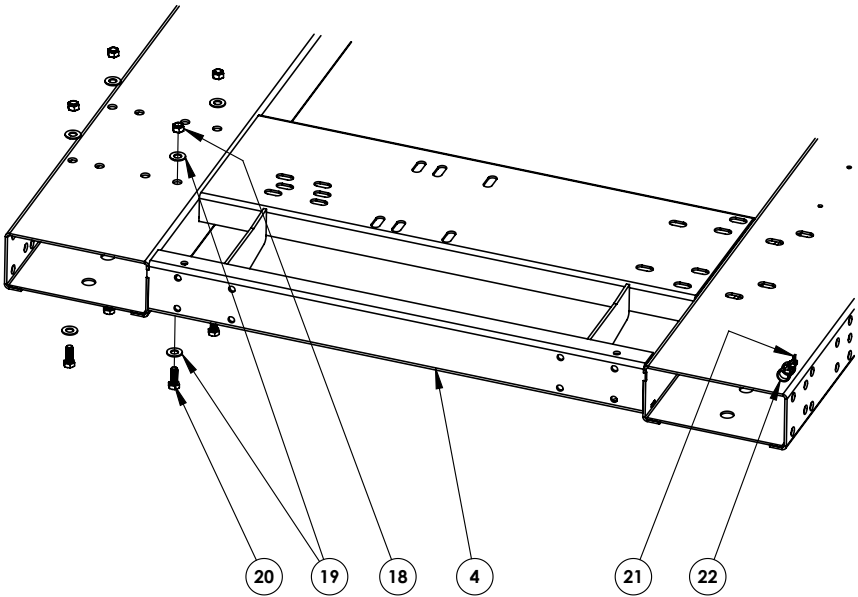

ICE MASTER® T-SERIES

PARTS LIST

ITEM NO.	Part #	DESCRIPTION	QTY.
1	THD00500OE-NF	500 Gal Sump Bot Tank	1
2	AVB355	STBBS35 Lg Baffle Ball	46
3	CFLP16HV	16 inch Hypro Lid Hinged	1
4	AZFP0500SS	500 Gallon Pro Master™ Frame - 304 Stainless Steel	1
5	CBTF200	2 Poly Tank Flange Assembly	1
6	CBHB20090	2" Male Thread x 2" Hose Shank 90	2
7	CBTC231	2" T-Bolt Hose Clamp 2.31 MIN	3
8	CBBF235	2" Bolted Tank Flange	1
9	CBTF075	3/4-in Poly Tank Fitting	2
10	CLUVGC03504	.75 Site Gauge Hose	1
11	CFPE04M04B	3/4 MNPT x 3/4 Hose Barb 90	2
12	CFCW001	Clamp For 3/4" Hose	2
13	CPA0100	Ice Master Base Mount Hose Reel	1
14	CHBS041323	7/16 x 3 Stainless Steel Bolt	12
15	AZP03SS	15-16 x 10" SS tie down pin	6
16	CHWZF045	7/16 flat washer	12
17	CHNS0423	7/16 Nylock Nut	12
18	CHNSN0323	3/8" SS Nylock Nut	4
19	CHWSF033	3/8" SS Flat Washer	8
20	CHBS030523	3-8" x 1" SS Hex Bolt	4
21	CXT0001	Cable Tie 14"	1
22	CXSC0002	Cable Tie 8"	1
23	CLUPEB10009	2" hose (tank return)	1
24	CLUPEB10009	2" hose (tank to pump)	1
25	CBM220BRB	2 Full Port Flange x 2 Hose Barb	1
26	IMSB12	Poly IMS Boom 12 Nozzle	1

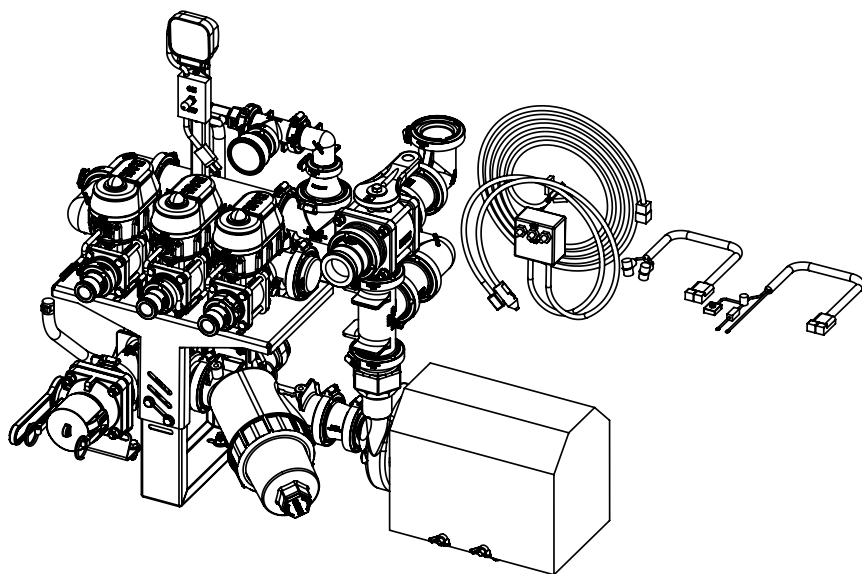

T-SERIES ECOMAX NON GPS PLUMBING 2023

DETAIL VIEWS

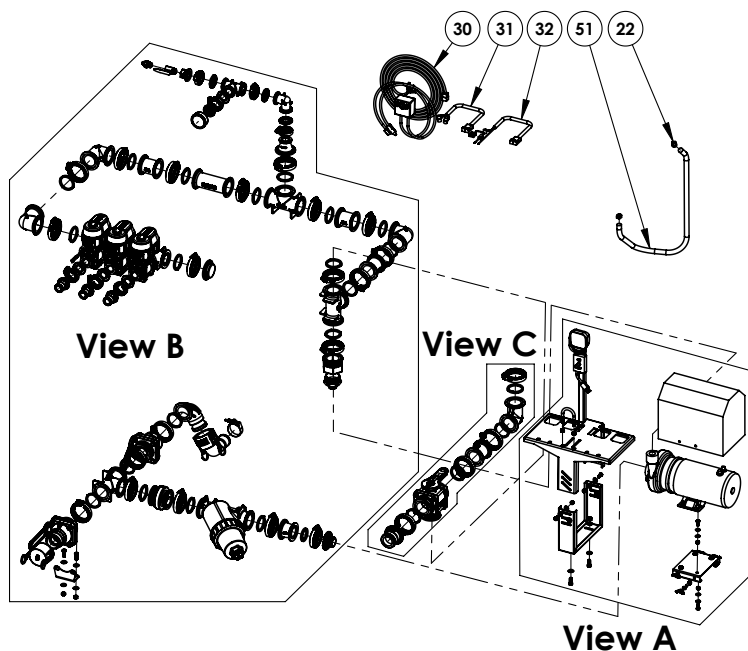

VIEW A

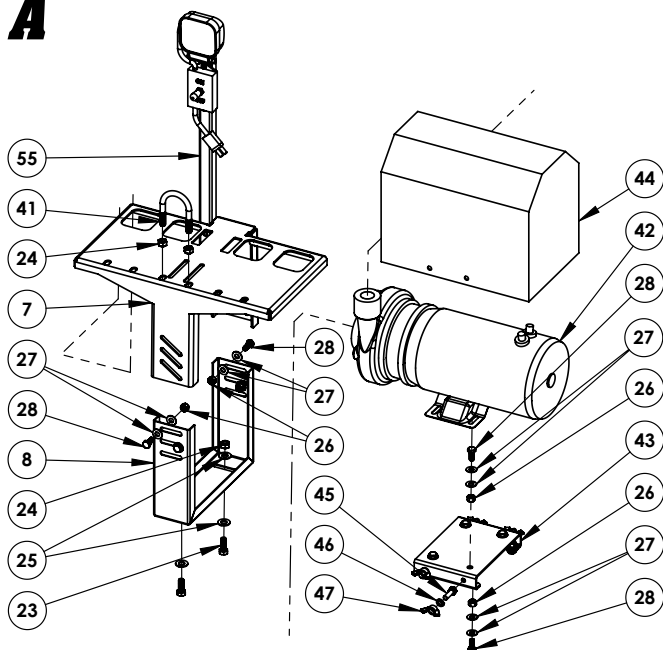

VIEW B

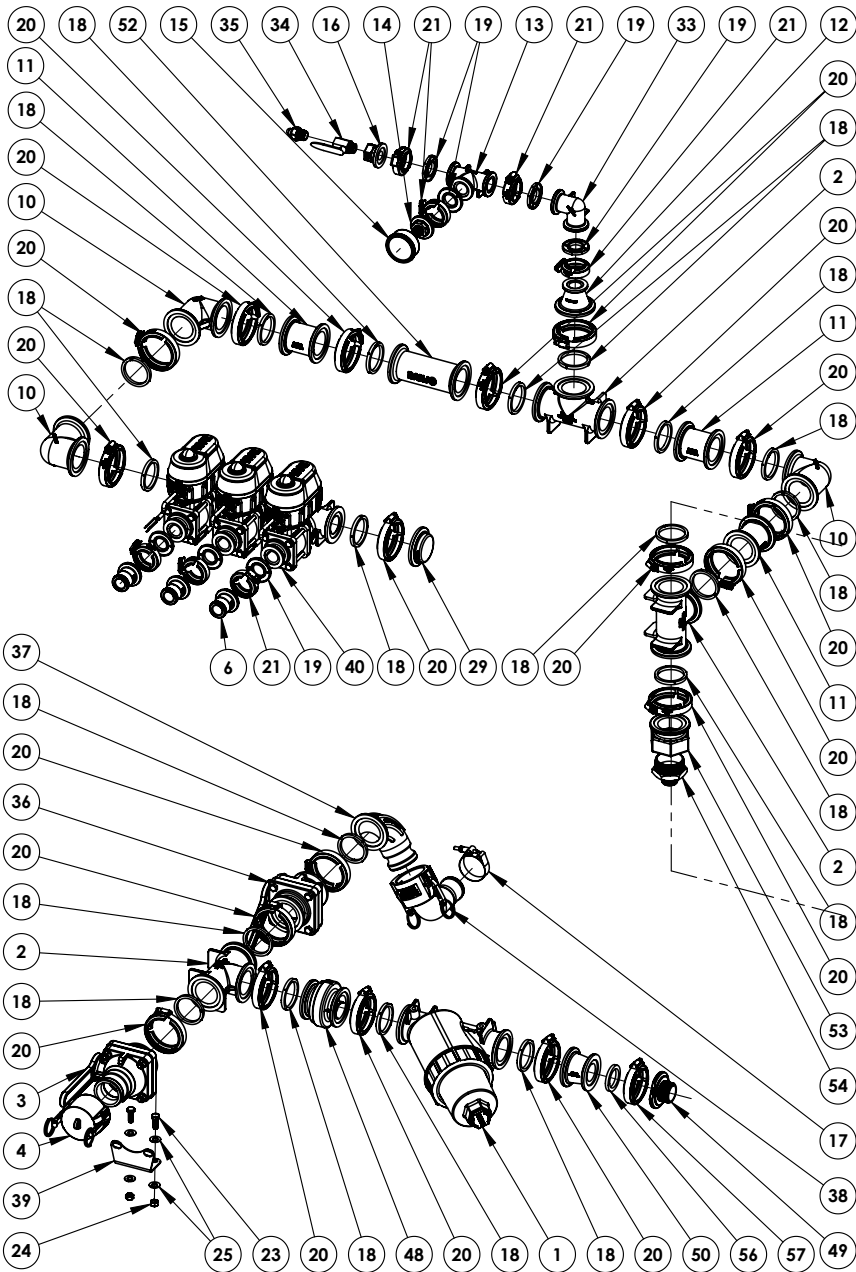

ICE MASTER® T-SERIES

VIEW C

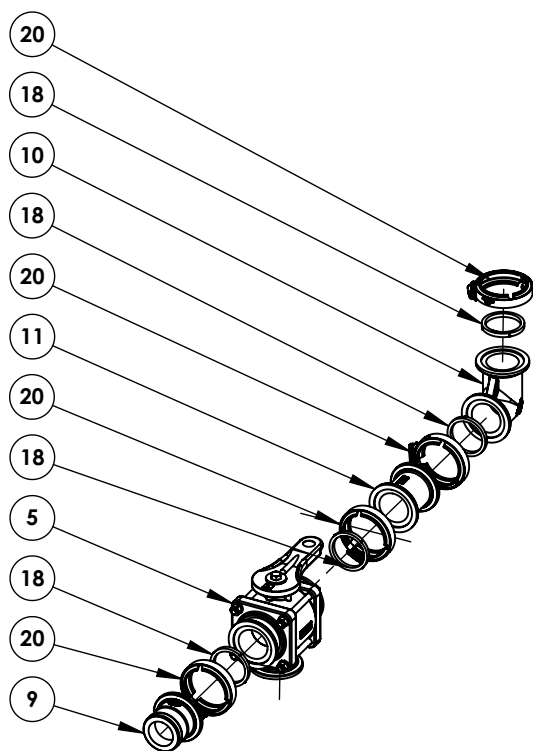

PARTS LIST

ITEM NO.	Part #	DESCRIPTION	QTY.
1	CBMLS22216	MLS222 Y-Strainer 16 Mesh	1
2	CBM220TEE	2 Manifold Tee - 220 Series	3
3	CBMVSF220FP	2-in FP Manifold x 2-in Male Adaptor	1
4	CB200CAP	2-in Cap	1
5	CBMV220BLSH	2" FP Bot Load Manifold Valve w/ SH Handle	1
6	CBM100A	1" Flange x 1" Male Adapter	3
7	AZKF0027	Deicing valve bracket wide top support	1
8	AZKF0021	Deicing Valve Bracket Base	1
9	CBM220A	2 IN FP Male Adapter x 2 IN Manifold	1
10	CBM220CPG90	2" FP x 2" FP Manifold Coupling 90°	4
11	CBM220CPG	2 x 2 Full Port Flange	4
12	CBM220100CPG	2" Full Port Flange x 1" Reducer Flange	1
13	CBM100TEE	1" Manifold Tee	1
14	CBM100PLG025	1 IN Flange x .25 FPT	1
15	CV2240GXB100	Pressure gauge 100psi Glycerin filled	1
16	CBM100050FPT	1 IN Flange x .5 IN Female Thread	1
17	CBTC231	2" T-Bolt Hose Clamp 2.31 MIN	1
18	CBM221G	2" FP Manifold Gasket with Rib	23
19	CBM102G	1-in Manifold Gasket with Skirt	7
20	CBFC220	2 SS Flange Worm Screw Clamp	23
21	CBFC100	1" Worm Screw Flange Clamp	7
22	CFCC003	Clamp for 1/2" Hose	2
23	CHBS030523	3-8" x 1" SS Hex Bolt	4
24	CHNSN0323	3/8" SS Nylock Nut	6
25	CHWSF033	3/8" SS Flat Washer	8
26	CHNSN0223	5-16 SS Nyloc Nut	12
27	CHWSF023	5/16" SS Flat Washer	24
28	CHBS020323	5-16 x .75 SS Bolt	12
29	CBM220PLG	2 IN Full Port Flange Plug	1
30	CEWCIM03	16 GA IM Wire Harness-3 toggle switch	1
31	CEWCIM11	Ecomax pump 4 foot harness with plug	1
32	CEWCIM13	Ecomax pump harness with fuse-solenoid-battery hook-up-in cab switch	1
33	CBM100CPG90	1" Manifold Coupling 90	1
34	CVS34DZO	.5 IN FPT x .5 IN MPT Ball Valve	1
35	CBHB05090	1/2 MNPT x 1/2 Hose Shank 90	1
36	CBMVS220CF	2-in Full Port Stubby Manifold Valve	1
37	CBM220ASWP90	2 inch Full Port Flange x Hose Shank Sweep	1
38	CB200C90	90 Female coupling to hose shank	1
39	CBV25271	90 degree Mounting Bracket	1
40	CBMEVX1013C	1 inch Manifold 3 Bank Electric Valve Assembly 3 pin connect	1
41	CHUS031234002	1.75 SS U-Bolt	1
42	APAMT001	12V IMS Ecomax pump	1

PARTS LIST

ITEM NO.	Part #	DESCRIPTION	QTY.
43	CSLC432	12V Heavy Duty Pump Plate	1
44	AVPC03	EcoMax Pump Cover	1
45	CHBS020523	5-16 x 1 Bolt Stainless Steel	4
46	CHWSL023	5-16 SS Lock Washer	4
47	CHNSW0323	3/8 Wingnut SS	4
48	CBMCV220	2 inch Full Port Manifold Checkvalve Assembly	1
49	CBM200125MPTSS	2 IN FP Flange x 1.25 IN Male Thread	1
50	CBM220200CPG	2 inch Full Port Flange x 2 inch Reducer Flange	1
51	CLUESB020002	1/2" hose (to hose reel)	1
52	CBM220CPG6	2 x 2 Full Port Flange x 6"	1
53	CBM220FPT	2 IN FP Manifold x 2 IN Female Thread	1
54	CFSRN09M05M	1in to 2in SS reducer nipple	1
55	IMSLB01	IMS T-series light kit	1
56	CB150G	1-1/2 inch EPDM Gasket	1
57	CBFC200	2 SS Flange Worm Screw Clamp	1

ECOMAX GPS

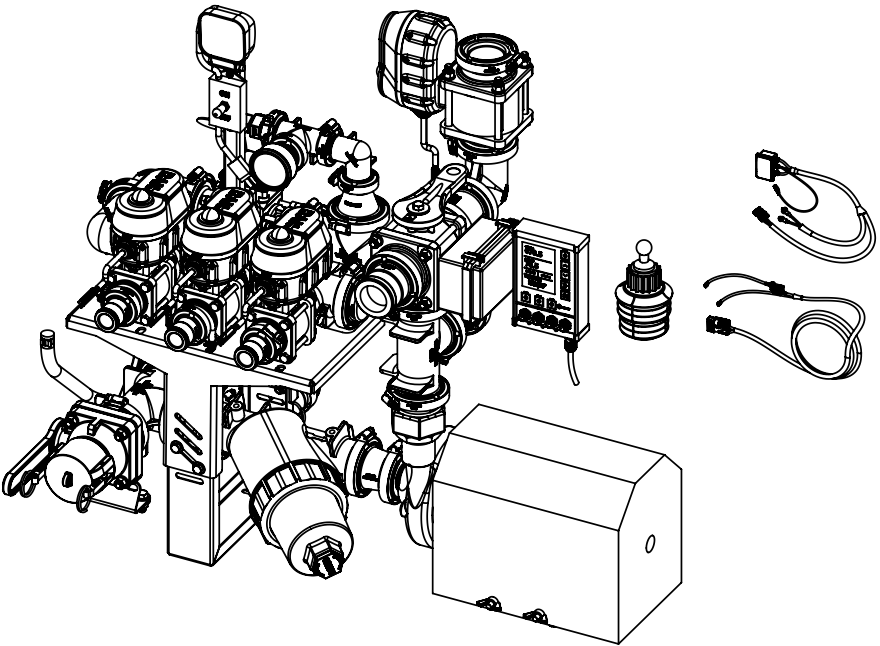

ICE MASTER® T-SERIES

T-SERIES ECOMAX GPS PLUMBING 2023

DETAIL VIEW

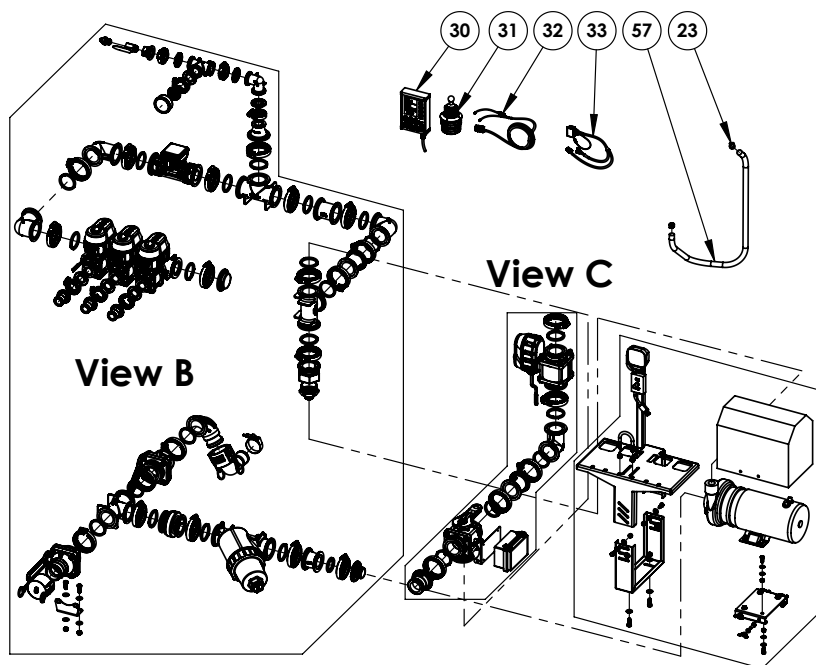

VIEW A

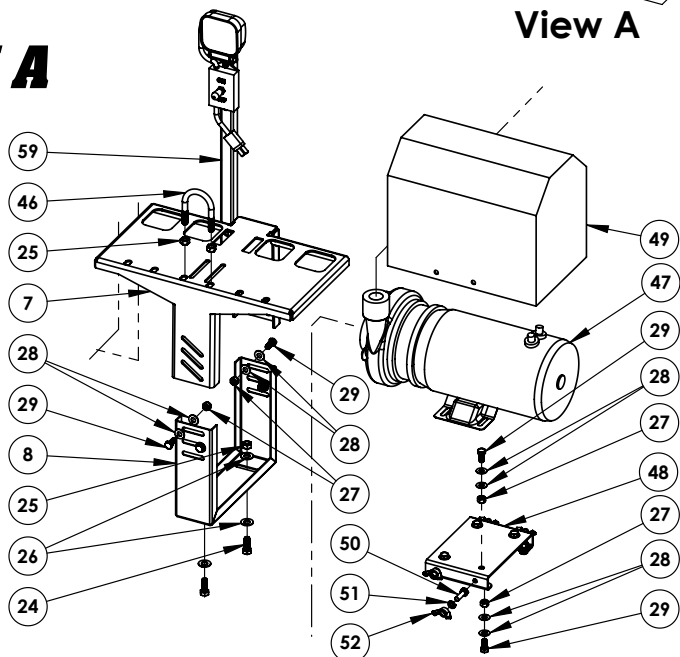

VIEW B

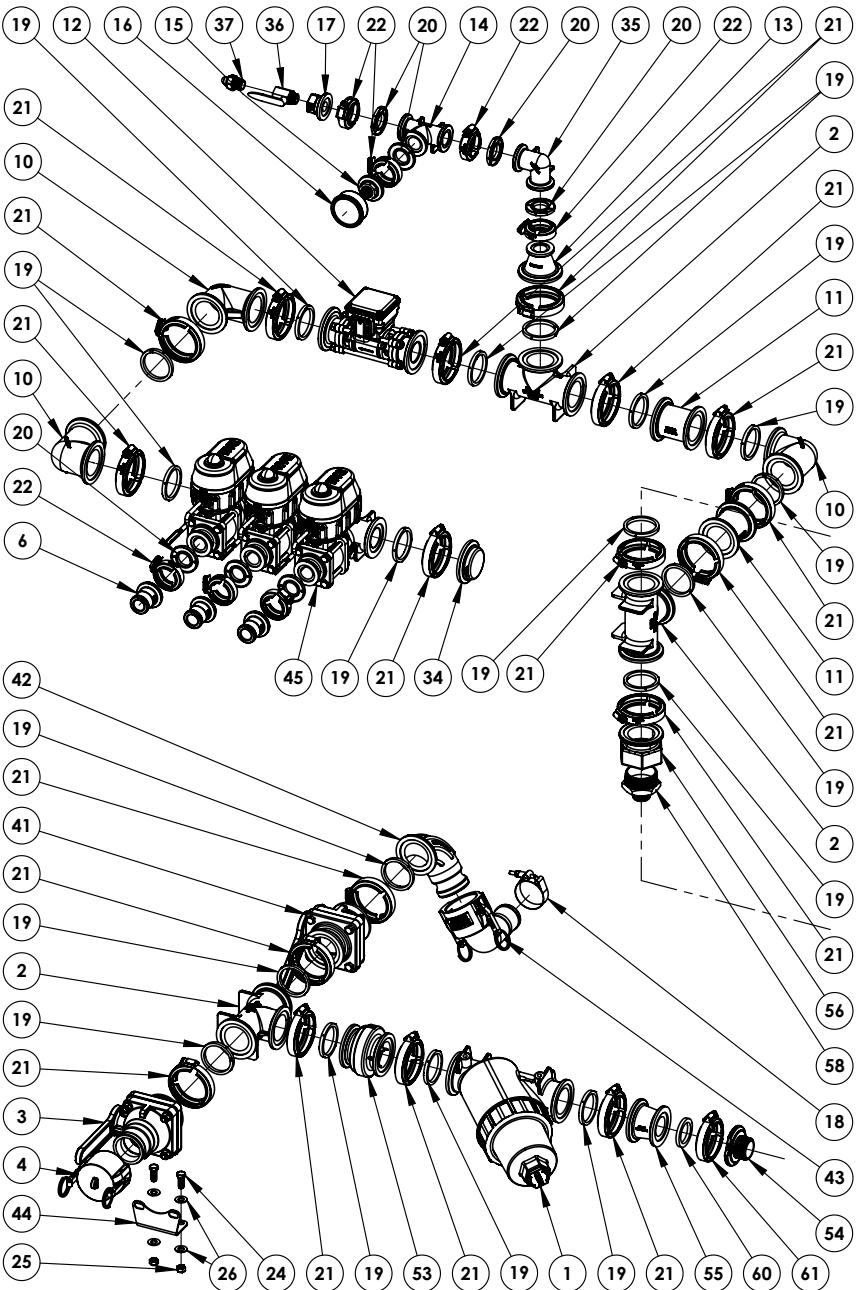

ICE MASTER® T-SERIES

VIEW C

ICE MASTER® T-SERIES

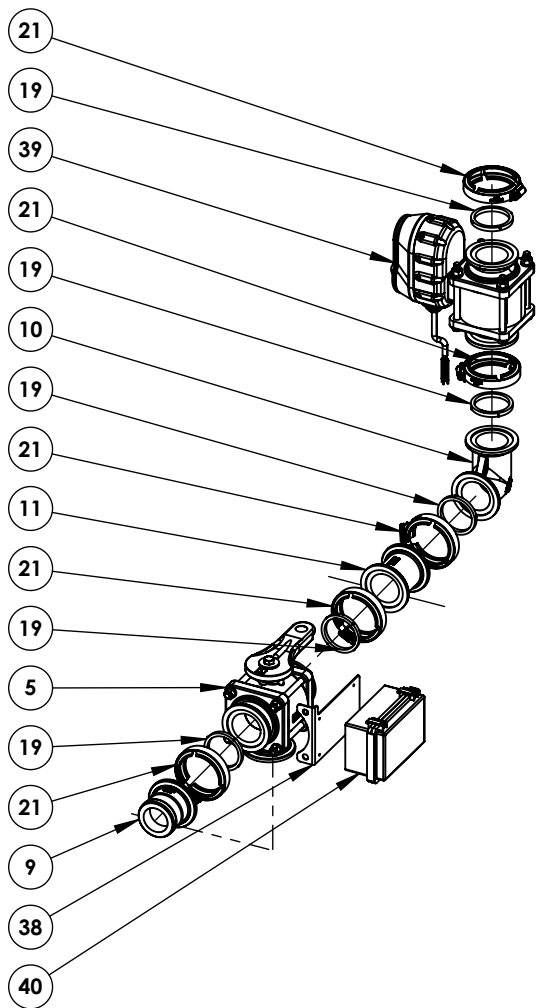

PARTS LIST

ITEM NO.	Part #	DESCRIPTION	QTY.
1	CBMLS22216	MLS222 Y-Strainer 16 Mesh	1
2	CBM220TEE	2 Manifold Tee - 220 Series	3
3	CBMVSF220FP	2-in FP Manifold x 2-in Male Adaptor	1
4	CB200CAP	2-in Cap	1
5	CBMV220BLSH	2" FP Bot Load Manifold Valve w/ SH Handle	1
6	CBM100A	1" Flange x 1" Male Adapter	3
7	AZKF0027	Deicing valve bracket wide top support	1
8	AZKF0021	Deicing Valve Bracket Base	1
9	CBM220A	2 IN FP Male Adapter x 2 IN Manifold	1
10	CBM220CPG90	2" FP x 2" FP Manifold Coupling 90°	4
11	CBM220CPG	2 x 2 Full Port Flange	3
12	CA46221A58787	Electro-Magnetic Flowmeter with 2 inch Full Port	1
13	CBM220100CPG	2" Full Port Flange x 1" Reducer Flange	1
14	CBM100TEE	1" Manifold Tee	1
15	CBM100PLG025	1 IN Flange x .25 FPT	1
16	CV2240GXB100	Pressure gauge 100psi Glycerin filled	1
17	CBM100050FPT	1 IN Flange x .5 IN Female Thread	1
18	CBTC231	2" T-Bolt Hose Clamp 2.31 MIN	1
19	CBM221G	2" FP Manifold Gasket with Rib	23
20	CBM102G	1-in Manifold Gasket with Skirt	7
21	CBFC220	2 SS Flange Worm Screw Clamp	23
22	CBFC100	1" Worm Screw Flange Clamp	7
23	CFCC003	Clamp for 1/2" Hose	2
24	CHBS030523	3-8" x 1" SS Hex Bolt	4
25	CHNSN0323	3/8" SS Nylock Nut	6
26	CHWSF033	3/8" SS Flat Washer	8
27	CHNSN0223	5-16 SS Nyloc Nut	12
28	CHWSF023	5/16" SS Flat Washer	24
29	CHBS020323	5-16 x .75 SS Bolt	12
30	CEC063	SC InCab Ctrl	1
31	CEC057	Cupholder Mount For GPS Controller	1
32	CEWCIM30	HF 12V PumpHarness/Breaker/175 Amp Waytek plug no solenoid	1
33	CEWCIM29	HF 12 V Pump 4' Harness w/big 175 AMP Waytek plug with solenoid	1
34	CBM220PLG	2 IN Full Port Flange Plug	1
35	CBM100CPG90	1" Manifold Coupling 90	1
36	CVS34DZO	.5 IN FPT x .5 IN MPT Ball Valve	1
37	CBHB05090	1/2 MNPT x 1/2 Hose Shank 90	1
38	CSLC723	MTS Controller Valve Bracket	1
39	CBMEVXR2W220A	2 IN Bolted Full Port Reg Valve w3pin WP Con	1
40	CEC065	STORM COMMANDER RECEIVER BOX	1
41	CBMVS220CF	2-in Full Port Stubby Manifold Valve	1
42	CBM220ASWP90	2 inch Full Port Flange x Hose Shank Sweep	1

PARTS LIST

ITEM NO.	Part #	DESCRIPTION	QTY.
43	CB200C90	90 Female coupling to hose shank	1
44	CBV25271	90 degree Mounting Bracket	1
45	CBMEVX1013C	1 inch Manifold 3 Bank Electric Valve Assembly 3 pin connect	1
46	CHUS031234002	1.75 SS U-Bolt	1
47	APAMT001	12V IMS Ecomax pump	1
48	CSLC432	12V Heavy Duty Pump Plate	1
49	AVPC03	EcoMax Pump Cover	1
50	CHBS020523	5-16 x 1 Bolt Stainless Steel	4
51	CHWSL023	5-16 SS Lock Washer	4
52	CHNSW0323	3/8 Wingnut SS	4
53	CBMCV220	2 inch Full Port Manifold Checkvalve Assembly	1
54	CBM200125MPTSS	2 IN FP Flange x 1.25 IN Male Thread	1
55	CBM220200CPG	2 inch Full Port Flange x 2 inch Reducer Flange	1
56	CBM220FPT	2 IN FP Manifold x 2 IN Female Thread	1
57	CLUESB020002	1/2" hose (to hose reel)	1
58	CFSRN09M05M	1in to 2in SS reducer nipple	1
59	IMSLB01	IMS T-series light kit	1
60	CB150G	1-1/2 inch EPDM Gasket	1
61	CBFC200	2 SS Flange Worm Screw Clamp	1

GAS NON GPS

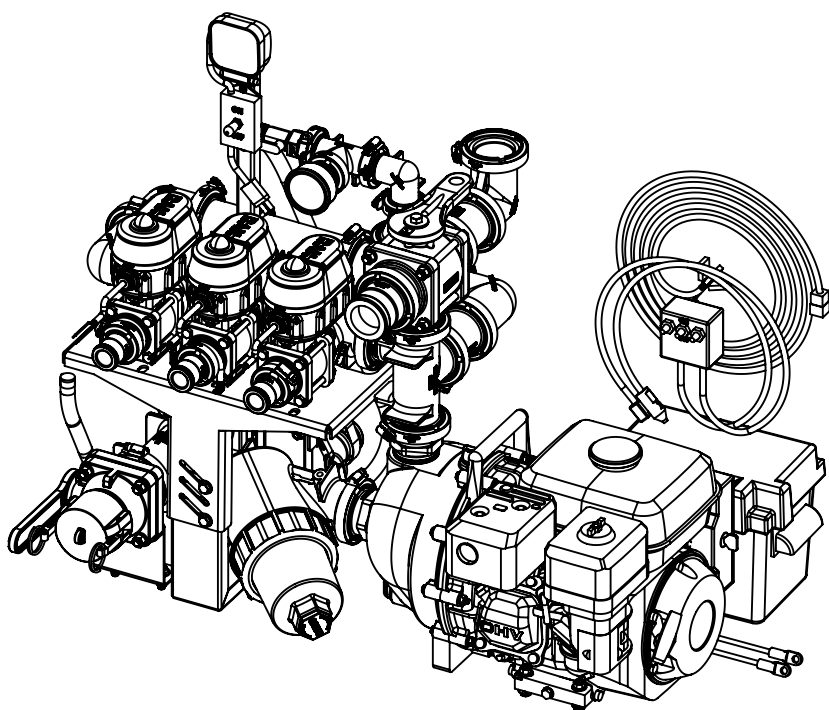

ICE MASTER® T-SERIES

T-SERIES GAS NON GPS PLUMBING 2023

DETAIL VIEW

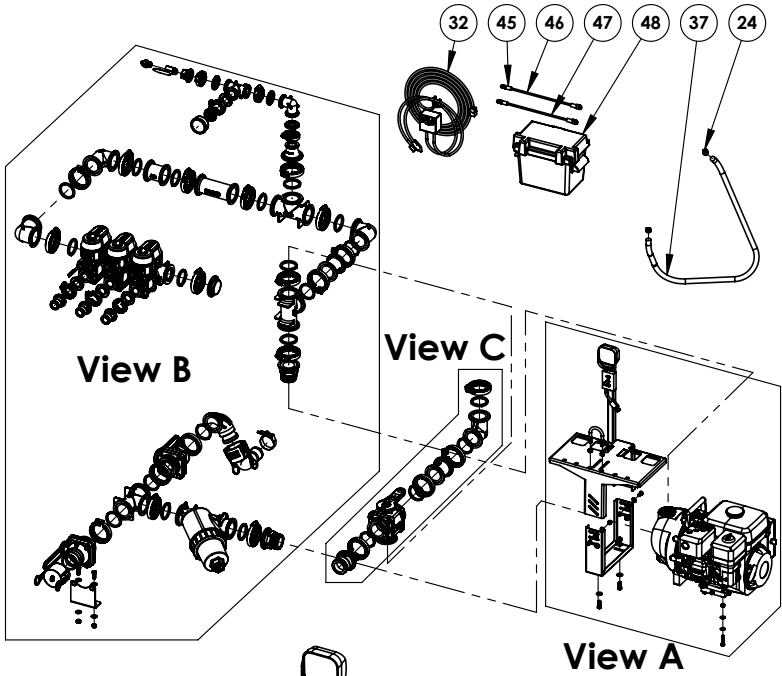

VIEW A

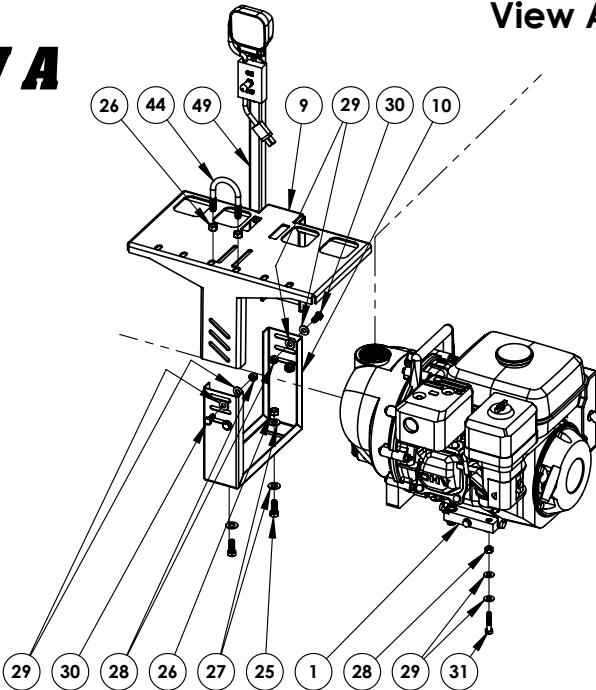

VIEW B

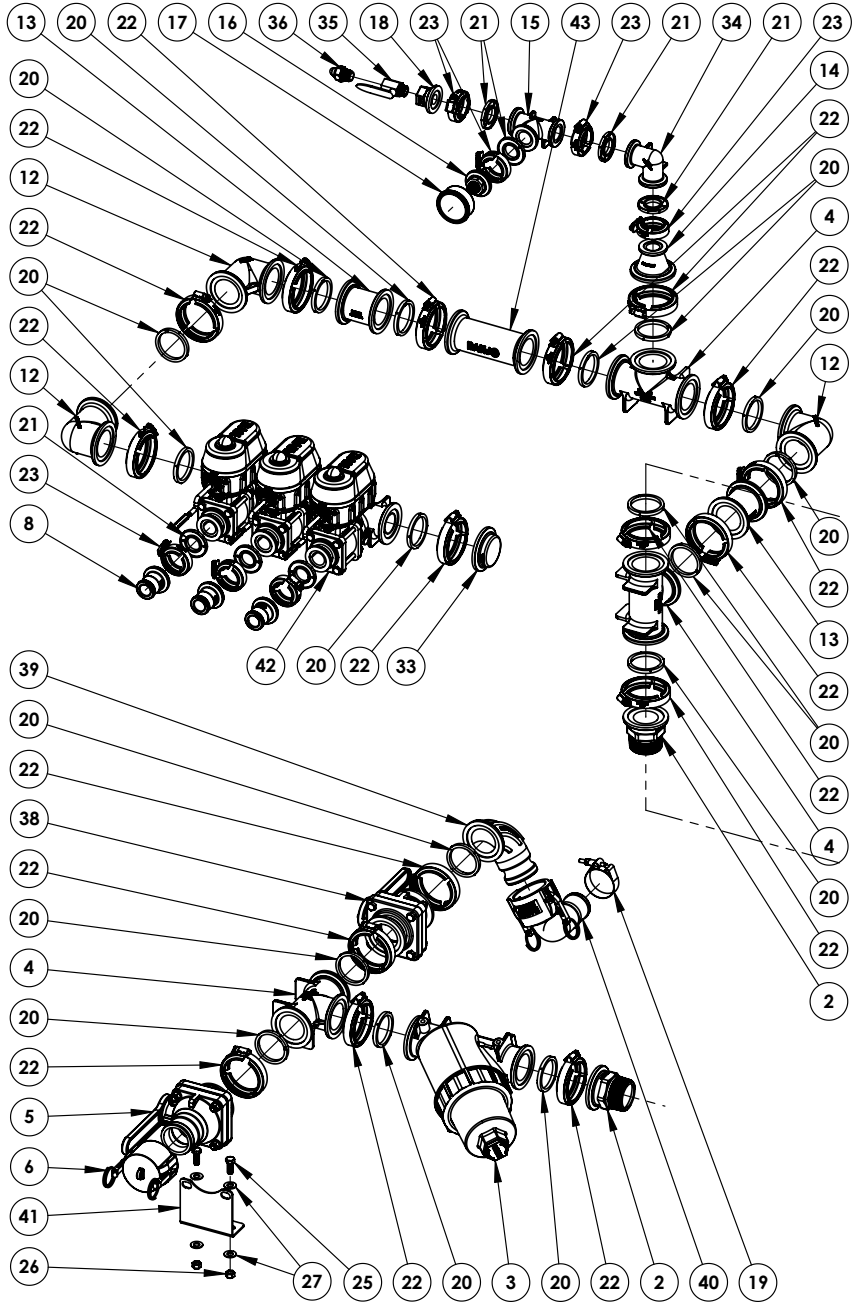

ICE MASTER® T-SERIES

VIEW C

ICE MASTER® T-SERIES

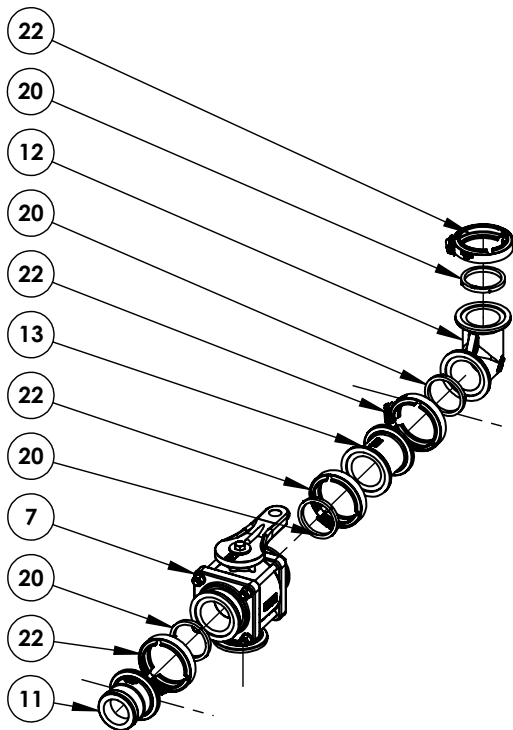

PARTS LIST

ITEM NO.	Part #	DESCRIPTION	QTY.
1	CB200PH5E	2 inch Poly Pump with 5.5HP Honda Engine Electric Start	1
2	CBM220MPT	2-in FP Manifold x 2-in Male Thread	2
3	CBMLS22216	MLS222 Y-Strainer 16 Mesh	1
4	CBM220TEE	2 Manifold Tee - 220 Series	3
5	CBMVSF220FP	2-in FP Manifold x 2-in Male Adaptor	1
6	CB200CAP	2-in Cap	1
7	CBMV220BLSH	2" FP Bot Load Manifold Valve w/ SH Handle	1
8	CBM100A	1" Flange x 1" Male Adapter	3
9	AZKF0027	Deicing valve bracket wide top support	1
10	AZKF0021	Deicing Valve Bracket Base	1
11	CBM220A	2 IN FP Male Adapter x 2 IN Manifold	1
12	CBM220CPG90	2" FP x 2" FP Manifold Coupling 90°	4
13	CBM220CPG	2 x 2 Full Port Flange	3
14	CBM220100CPG	2" Full Port Flange x 1" Reducer Flange	1
15	CBM100TEE	1" Manifold Tee	1
16	CBM100PLG025	1 IN Flange x .25 FPT	1
17	CV2240GX8100	Pressure gauge 100psi Glycerin filled	1
18	CBM100050FPT	1 IN Flange x .5 IN Female Thread	1
19	CBTC231	2" T-Bolt Hose Clamp 2.31 MIN	1
20	CBM221G	2" FP Manifold Gasket with Rib	21
21	CBM102G	1-in Manifold Gasket with Skirt	7
22	CBFC220	2 SS Flange Worm Screw Clamp	21
23	CBFC100	1" Worm Screw Flange Clamp	7
24	CFCC003	Clamp for 1/2" Hose	2
25	CHBS030523	3-8" x 1" SS Hex Bolt	4
26	CHNSN0323	3/8" SS Nylock Nut	6
27	CHWSF033	3/8" SS Flat Washer	8
28	CHNSN0223	5-16 SS Nyloc Nut	8
29	CHWSF023	5/16" SS Flat Washer	16
30	CHBS020323	5-16 x .75 SS Bolt	4
31	CHBS020723	5/16" x 1-1/2" SS Bolt	4
32	CEWCIM03	16 GA IM Wire Harness-3 toggle switch	1
33	CBM220PLG	2 IN Full Port Flange Plug	1
34	CBM100CPG90	1" Manifold Coupling 90	1
35	CVS34DZO	.5 IN FPT x .5 IN MPT Ball Valve	1
36	CBHB05090	1/2 MNPT x 1/2 Hose Shank 90	1
37	CLUESB020002	1/2" hose (to hose reel)	1
38	CBMV5220CF	2-in Full Port Stubby Manifold Valve	1
39	CBM220ASWP90	2 inch Full Port Flange x Hose Shank Sweep	1
40	CB200C90	90 Female coupling to hose shank	1
41	C5LC729	Valve Bracket for Gas T-Series	1
42	CBMEVX103A	3-bank electric Banjo Valve bolted with pin con	1
43	CBM220CPG6	2 x 2 Full Port Flange x 6"	1

PARTS LIST

ITEM NO.	Part #	DESCRIPTION	QTY.
44	CHUS031234002	1.75 SS U-Bolt	1
45	CTEW018	Battery Terminal - Standard Lug Plated	4
46	CTEW017	Battery Cable - 4GA. Black	1
47	CTEW016	Battery Cable - 4GA. Red	1
48	CTEW037	Battery Box, Polypropylene, for U1 Battery Size	1
49	IMSLB01	IMS T-series light kit	1

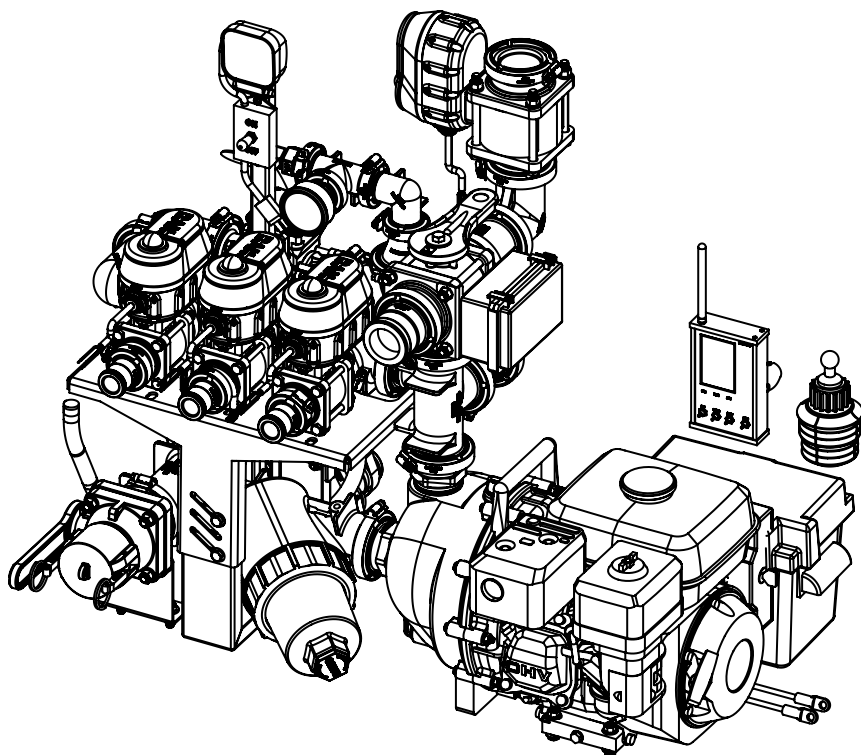

T-SERIES GAS GPS PLUMBING 2023

OVERVIEW

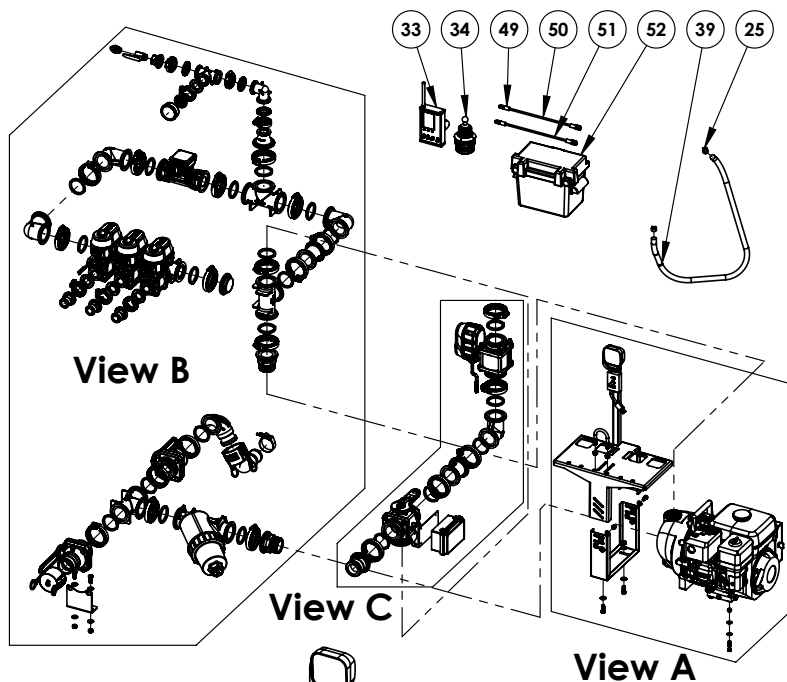

VIEW A

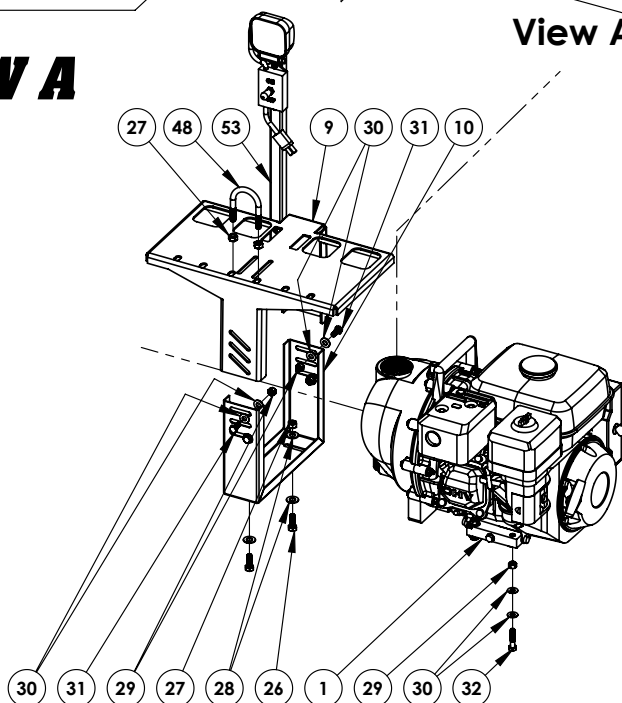

VIEW B

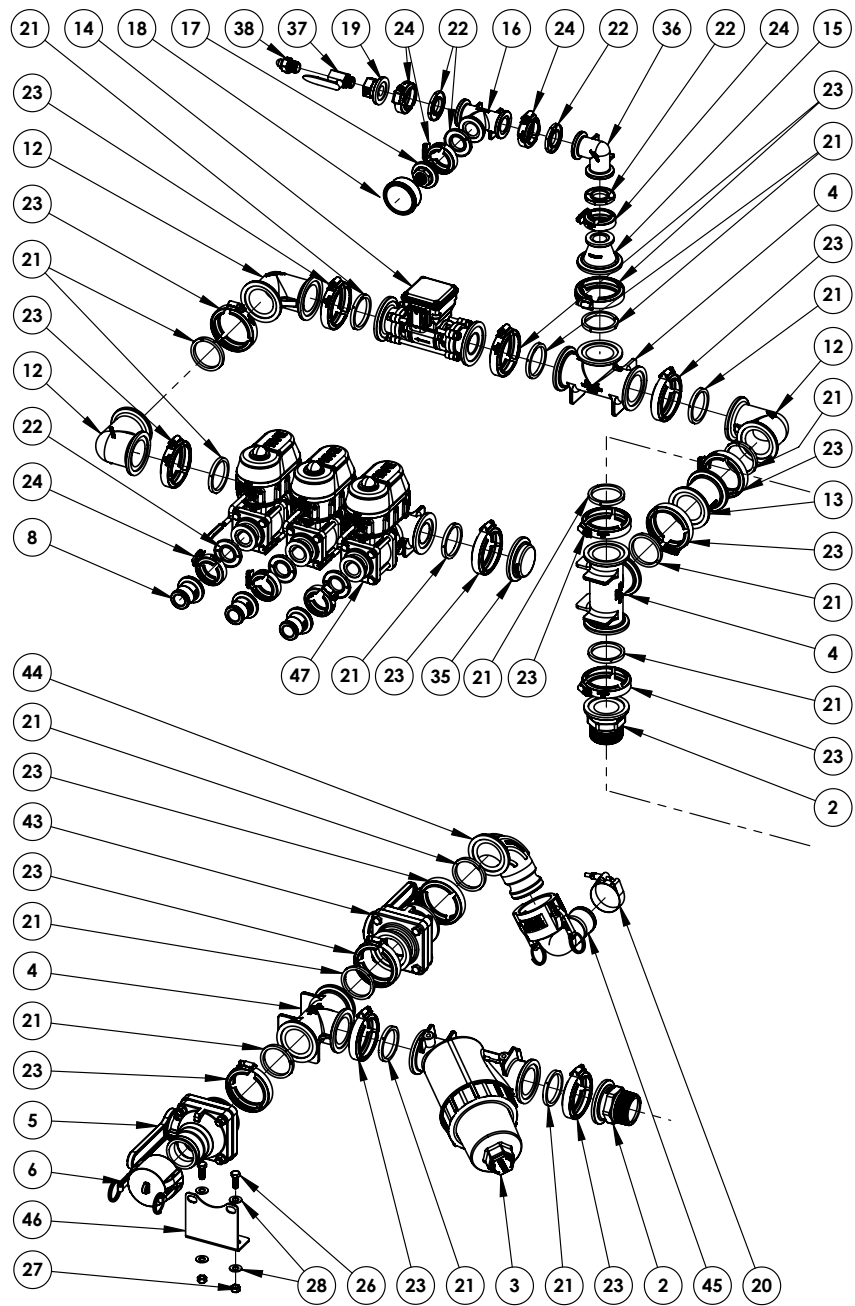

ICE MASTER® T-SERIES

VIEW C

ICE MASTER® T-SERIES

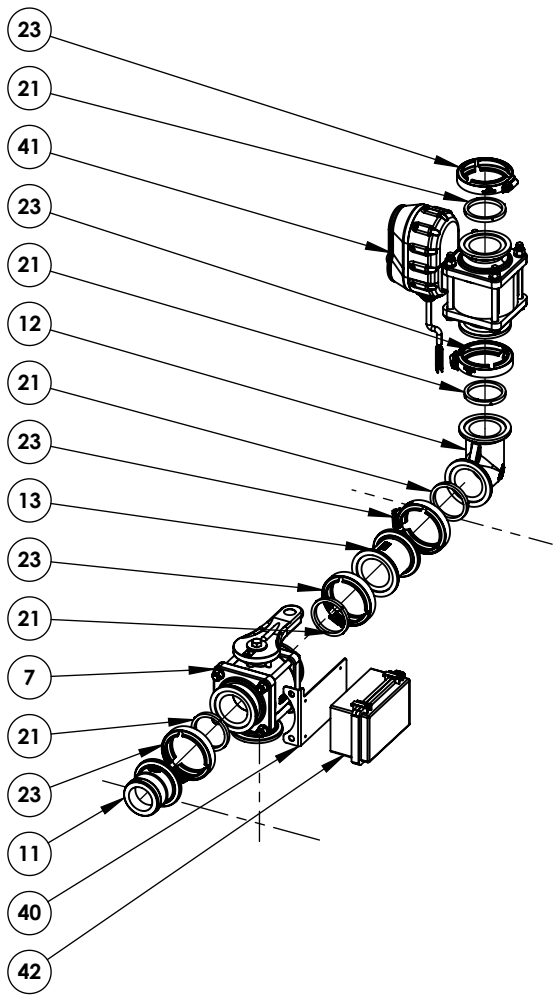

PARTS LIST

ITEM NO.	Part #	DESCRIPTION	QTY.
1	CB200PH5E	2 inch Poly Pump with 5.5HP Honda Engine Electric Start	1
2	CBM220MPT	2-in FP Manifold x 2-in Male Thread	2
3	CBMLS22216	MLS222 Y-Strainer 16 Mesh	1
4	CBM220TEE	2 Manifold Tee - 220 Series	3
5	CBMVSF220FP	2-in FP Manifold x 2-in Male Adaptor	1
6	CB200CAP	2-in Cap	1
7	CBMV220BLSH	2" FP Bot Load Manifold Valve w/ SH Handle	1
8	CBM100A	1" Flange x 1" Male Adapter	3
9	AZKF0027	Deicing valve bracket wide top support	1
10	AZKF0021	Deicing Valve Bracket Base	1
11	CBM220A	2 IN FP Male Adapter x 2 IN Manifold	1
12	CBM220CPG90	2" FP x 2" FP Manifold Coupling 90°	4
13	CBM220CPG	2 x 2 Full Port Flange	2
14	CA46221A58787	Electro-Magnetic Flowmeter with 2 inch Full Port	1
15	CBM220100CPG	2" Full Port Flange x 1" Reducer Flange	1
16	CBM100TEE	1" Manifold Tee	1
17	CBM100PLG025	1 IN Flange x .25 FPT	1
18	CV2240GXB100	Pressure gauge 100psi Glycerin filled	1
19	CBM100050FPT	1 IN Flange x .5 IN Female Thread	1
20	CBTC231	2" T-Bolt Hose Clamp 2.31 MIN	1
21	CBM221G	2" FP Manifold Gasket with Rib	21
22	CBM102G	1-in Manifold Gasket with Skirt	7
23	CBFC220	2 SS Flange Worm Screw Clamp	21
24	CBFC100	1" Worm Screw Flange Clamp	7
25	CFCC003	Clamp for 1/2" Hose	2
26	CHBS030523	3-8" x 1" SS Hex Bolt	4
27	CHNSN0323	3/8" SS Nylock Nut	6
28	CHWSF033	3/8" SS Flat Washer	8
29	CHNSN0223	5-16 SS Nyloc Nut	8
30	CHWSF023	5/16" SS Flat Washer	16
31	CHBS020323	5-16 x .75 SS Bolt	4
32	CHBS020723	5/16" x 1-1/2" SS Bolt	4
33	CEC056	Storm Commander controller -in-cab controller, wire hookups, control box at unit	1
34	CEC057	Cupholder Mount For GPS Controller	1
35	CBM220PLG	2 IN Full Port Flange Plug	1
36	CBM100CPG90	1" Manifold Coupling 90	1
37	CVS34DZO	.5 IN FPT x .5 IN MPT Ball Valve	1
38	CBHB05090	1/2 MNPT x 1/2 Hose Shank 90	1
39	CLUESB020002	1/2" hose (to hose reel)	1
40	CSLC723	MTS Controller Valve Bracket	1
41	CBMEVXR2W220A	2 IN Bolted Full Port Reg Valve w3pin WP Con	1
42	CEC065	STORM COMMANDER RECEIVER BOX	1

PARTS LIST

ITEM NO.	Part #	DESCRIPTION	QTY.
43	CBMVS220CF	2-in Full Port Stubby Manifold Valve	1
44	CBM220ASWP90	2 inch Full Port Flange x Hose Shank Sweep	1
45	CB200C90	90 Female coupling to hose shank	1
46	CSLC729	Valve Bracket for Gas T-Series	1
47	CBMEVX103A	3-bank electric Banjo Valve bolted with pin con	1
48	CHUS031234002	1.75 SS U-Bolt	1
49	CTEW018	Battery Terminal - Standard Lug Plated	4
50	CTEW017	Battery Cable - 4GA. Black	1
51	CTEW016	Battery Cable - 4GA. Red	1
52	CTEW037	Battery Box, Polypropylene, for U1 Battery Size	1
53	IMSLB01	IMS T-series light kit	1

HYDRAULIC GPS

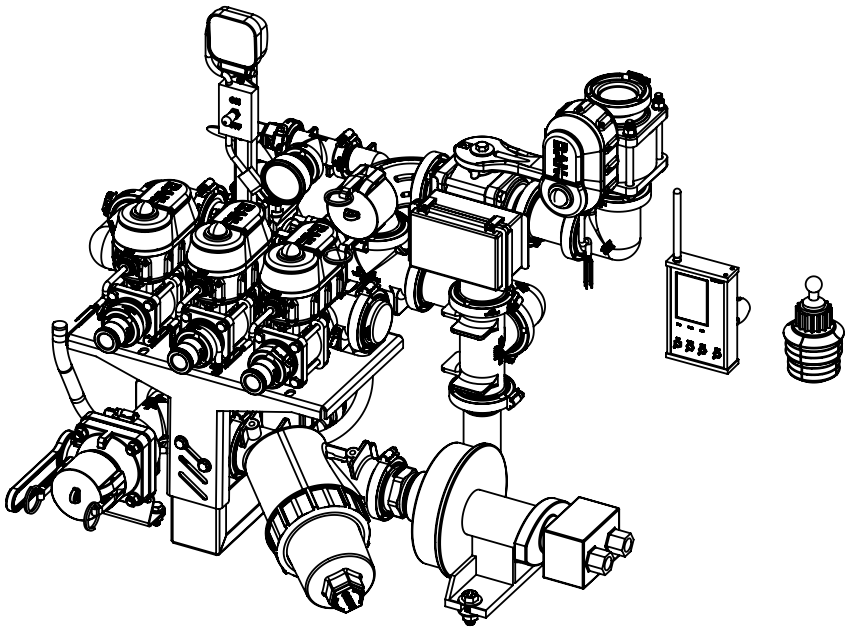

ICE MASTER® T-SERIES

HYDRAULIC GPS PLUMBING 2023

OVERVIEW

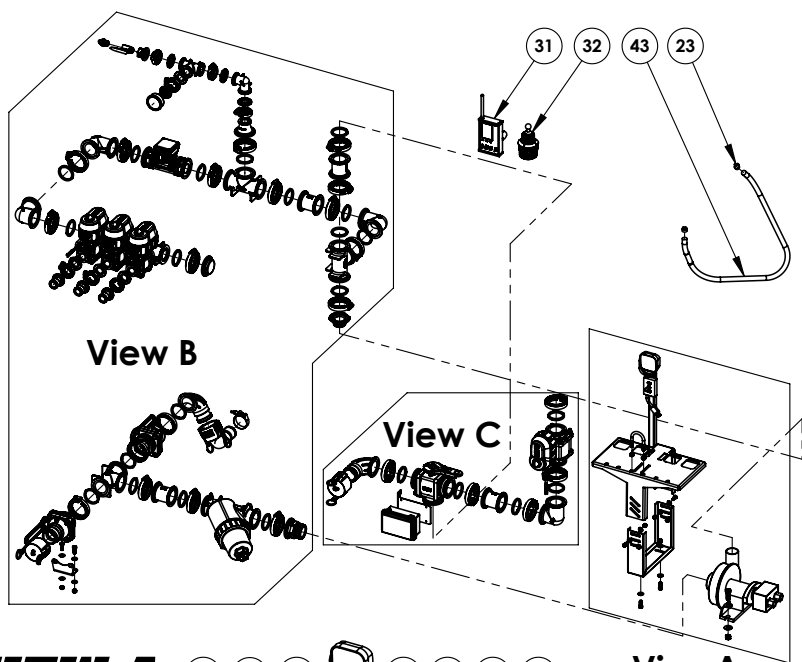

VIEW A

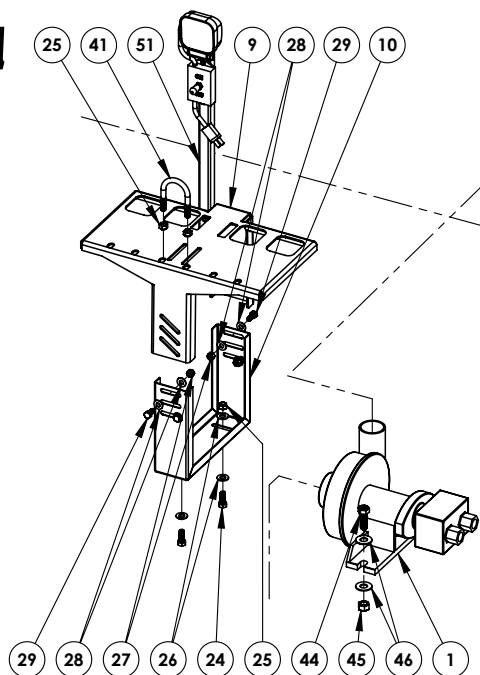

VIEW B

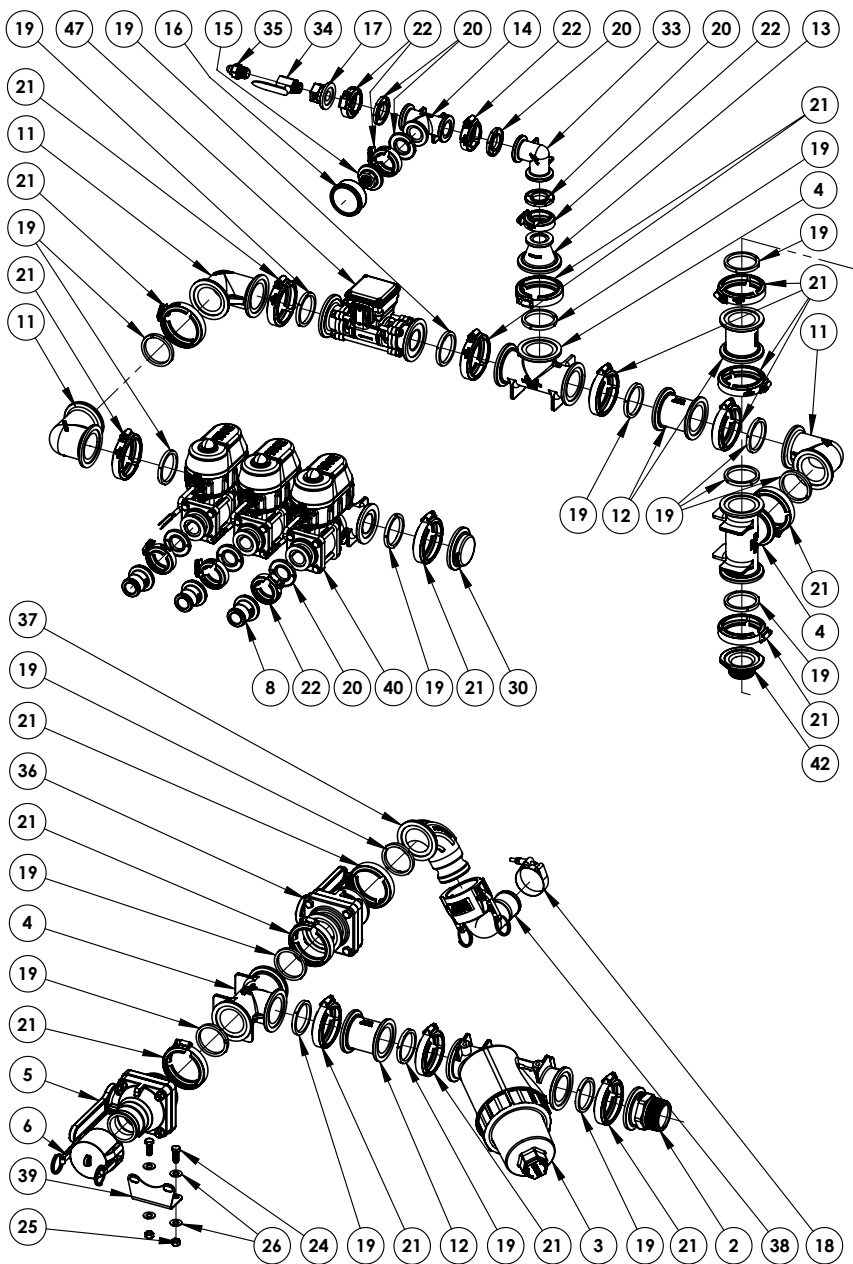

VIEW C

ICE MASTER® T-SERIES

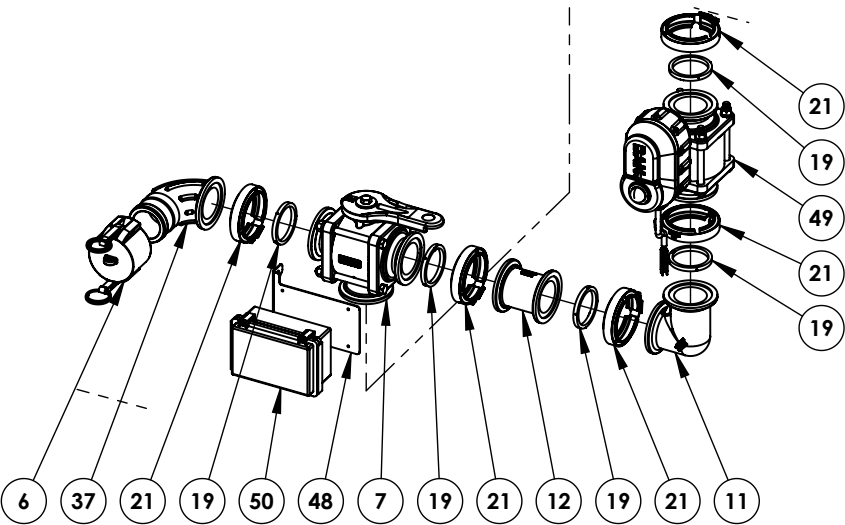

PARTS LIST

ITEM NO.	Part #	DESCRIPTION	QTY.
1	APDC09HS	SS Hydraulic pump	1
2	CBM220MPT	2-in FP Manifold x 2-in Male Thread	1
3	CBMLS22216	MLS222 Y-Strainer 16 Mesh	1
4	CBM220TEE	2 Manifold Tee - 220 Series	3
5	CBMVSF220FP	2-in FP Manifold x 2-in Male Adaptor	1
6	CB200CAP	2-in Cap	2
7	CBMV220BLSH	2" FP Bot Load Manifold Valve w/ SH Handle	1
8	CBM100A	1" Flange x 1" Male Adapter	3
9	AZKF0027	Deicing valve bracket wide top support	1
10	AZKF0021	Deicing Valve Bracket Base	1
11	CBM220CPG90	2" FP x 2" FP Manifold Coupling 90°	4
12	CBM220CPG	2 x 2 Full Port Flange	4
13	CBM220100CPG	2" Full Port Flange x 1" Reducer Flange	1
14	CBM100TEE	1" Manifold Tee	1
15	CBM100PLG025	1 IN Flange x .25 FPT	1
16	CV2240GXB100	Pressure gauge 100psi Glycerin filled	1
17	CBM100050FPT	1 IN Flange x .5 IN Female Thread	1
18	CBTC231	2" T-Bolt Hose Clamp 2.31 MIN	1
19	CBM221G	2" FP Manifold Gasket with Rib	23
20	CBM102G	1-in Manifold Gasket with Skirt	7
21	CBFC220	2 SS Flange Worm Screw Clamp	23
22	CBFC100	1" Worm Screw Flange Clamp	7
23	CFCC003	Clamp for 1/2" Hose	2
24	CHBS030523	3-8" x 1" SS Hex Bolt	4
25	CHNSN0323	3/8" SS Nylock Nut	6
26	CHWSF033	3/8" SS Flat Washer	8
27	CHNSN0223	5-16 SS Nyloc Nut	4
28	CHWSF023	5/16" SS Flat Washer	8
29	CHBS020323	5-16 x .75 SS Bolt	4
30	CBM220PLG	2 IN Full Port Flange Plug	1
31	CEC056	Storm Commander controller -in-cab controller, wire hookups, control box at unit	1
32	CEC057	Cupholder Mount For GPS Controller	1
33	CBM100CPG90	1" Manifold Coupling 90	1
34	CVS34DZO	.5 IN FPT x .5 IN MPT Ball Valve	1
35	CBHB05090	1/2 MNPT x 1/2 Hose Shank 90	1
36	CBMVS220CF	2-in Full Port Stubby Manifold Valve	1
37	CBM220ASWP90	2 inch Full Port Flange x Hose Shank Sweep	2
38	CB200C90	90 Female coupling to hose shank	1
39	CBV25271	90 degree Mounting Bracket	1
40	CBMEVX103A	3-bank electric Banjo Valve bolted with pin con	1
41	CHUS031234002	1.75 SS U-Bolt	1
42	CBM220150MPTSS	2 IN Full Port Flange x 1-1/2 inch MPT SS	1
43	CLUESB020002	1/2" hose (to hose reel)	1

PARTS LIST

ITEM NO.	Part #	DESCRIPTION	QTY.
44	CHAS050723	1/2" x 1-1/2" Stainless Hex Bolt All Thread	2
45	CHNSN0533	1/2" Nylock Nut 304 SS	2
46	CHWSF053	1/2 SS flat washer	4
47	CA46221A58787	Electro-Magnetic Flowmeter with 2 inch Full Port	1
48	CSLC723	MTS Controller Valve Bracket	1
49	CBMEVXR2W220A	2 IN Bolted Full Port Reg Valve w3pin WP Con	1
50	CEC065	STORM COMMANDER RECEIVER BOX	1
51	IMSLB01	IMS T-series light kit	1

HYDRAULIC NON GPS

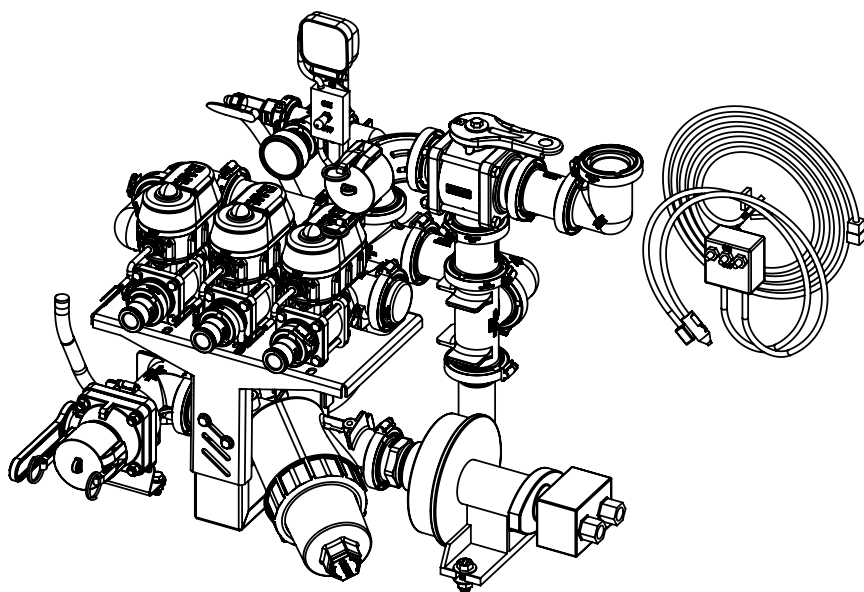

ICE MASTER® T-SERIES

HYDRAULIC NON GPS PLUMBING 2023

OVERVIEW

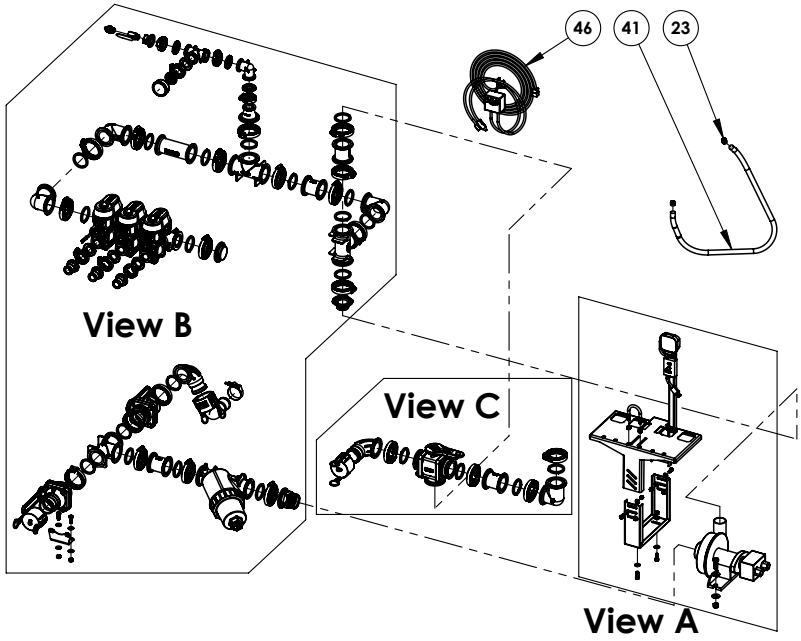

VIEW A

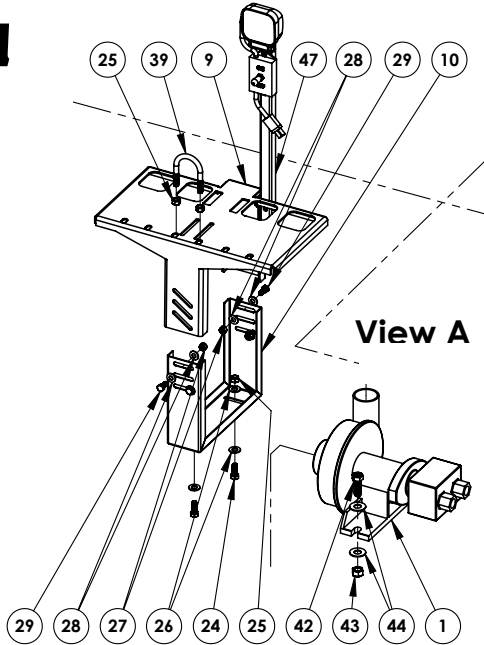

VIEW B

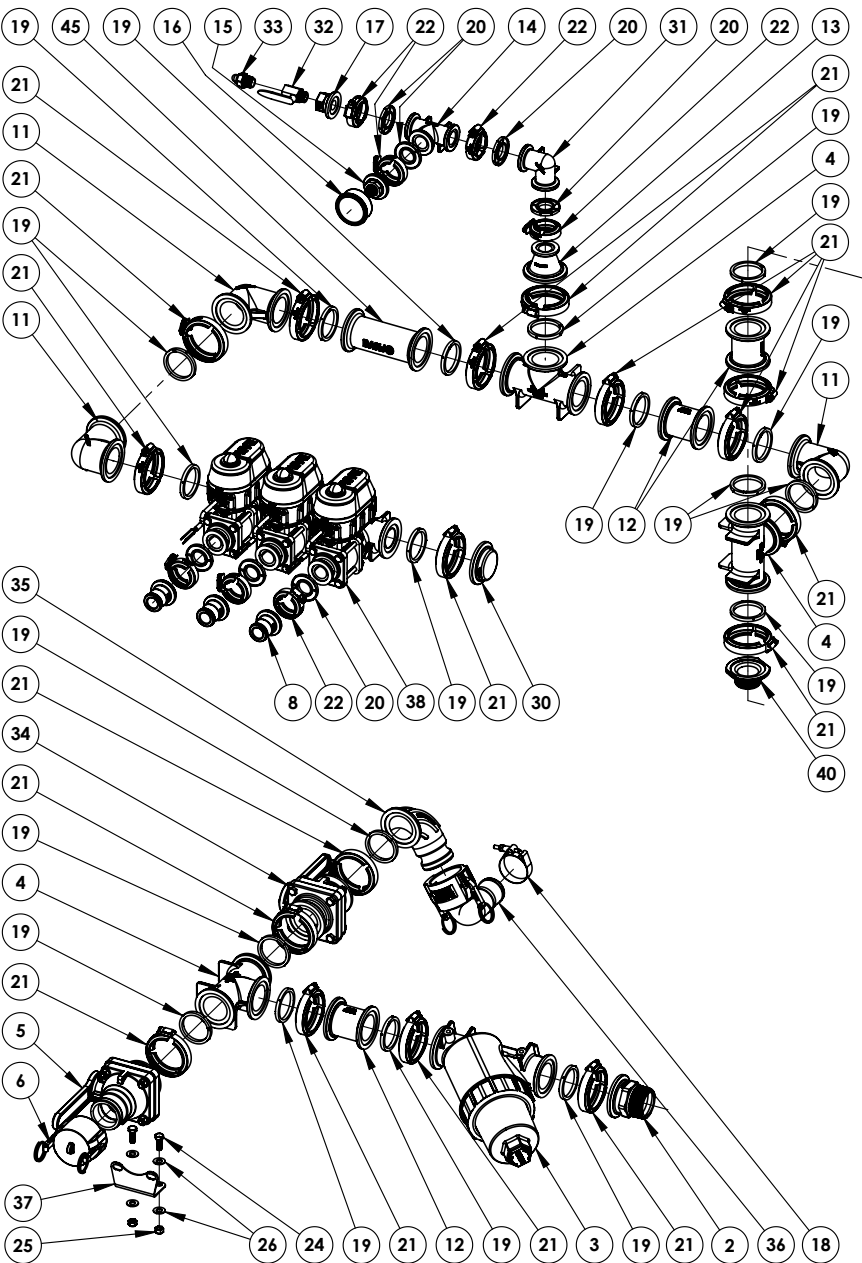

VIEW C

ICE MASTER® T-SERIES

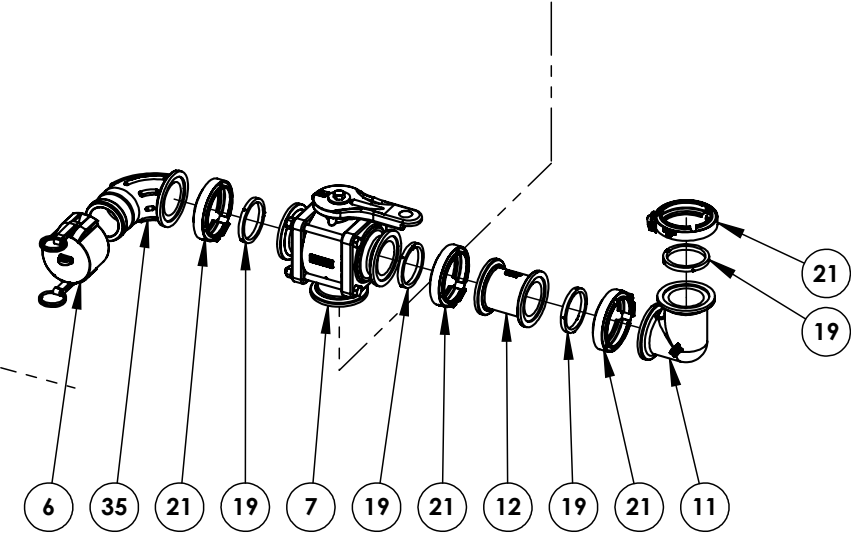

PARTS LIST

ITEM NO.	Part #	DESCRIPTION	QTY.
1	APDC09HS	SS Hydraulic pump	1
2	CBM220MPT	2-in FP Manifold x 2-in Male Thread	1
3	CBMLS22216	MLS222 Y-Strainer 16 Mesh	1
4	CBM220TEE	2 Manifold Tee - 220 Series	3
5	CBMVSF220FP	2-in FP Manifold x 2-in Male Adaptor	1
6	CB200CAP	2-in Cap	2
7	CBMV220BLSH	2" FP Bot Load Manifold Valve w/ SH Handle	1
8	CBM100A	1" Flange x 1" Male Adapter	3
9	AZKF0027	Deicing valve bracket wide top support	1
10	AZKF0021	Deicing Valve Bracket Base	1
11	CBM220CPG90	2" FP x 2" FP Manifold Coupling 90°	4
12	CBM220CPG	2 x 2 Full Port Flange	4
13	CBM220100CPG	2" Full Port Flange x 1" Reducer Flange	1
14	CBM100TEE	1" Manifold Tee	1
15	CBM100PLG025	1 IN Flange x .25 FPT	1
16	CV2240GXB100	Pressure gauge 100psi Glycerin filled	1
17	CBM100050FPT	1 IN Flange x .5 IN Female Thread	1
18	CBTC231	2" T-Bolt Hose Clamp 2.31 MIN	1
19	CBM221G	2" FP Manifold Gasket with Rib	22
20	CBM102G	1-in Manifold Gasket with Skirt	7
21	CBFC220	2 SS Flange Worm Screw Clamp	22
22	CBFC100	1" Worm Screw Flange Clamp	7
23	CFCC003	Clamp for 1/2" Hose	2
24	CHBS030523	3-8" x 1" SS Hex Bolt	4
25	CHNSN0323	3/8" SS Nylock Nut	6
26	CHWSF033	3/8" SS Flat Washer	8
27	CHNSN0223	5-16 SS Nyloc Nut	4
28	CHWSF023	5/16" SS Flat Washer	8
29	CHBS020323	5-16 x .75 SS Bolt	4
30	CBM220PLG	2 IN Full Port Flange Plug	1
31	CBM100CPG90	1" Manifold Coupling 90	1
32	CVS34DZO	.5 IN FPT x .5 IN MPT Ball Valve	1
33	CBHB05090	1/2 MNPT x 1/2 Hose Shank 90	1
34	CBMVS220CF	2-in Full Port Stubby Manifold Valve	1
35	CBM220ASWP90	2 inch Full Port Flange x Hose Shank Sweep	2
36	CB200C90	90 Female coupling to hose shank	1
37	CBV25271	90 degree Mounting Bracket	1
38	CBMEVX103A	3-bank electric Banjo Valve bolted with pin con	1
39	CHUS031234002	1.75 SS U-Bolt	1
40	CBM220150MPTSS	2 IN Full Port Flange x 1-1/2 inch MPT SS	1

PARTS LIST

ITEM NO.	Part #	DESCRIPTION	QTY.
41	CLUESB020002	1/2" hose (to hose reel)	1
42	CHAS050723	1/2" x 1-1/2" Stainless Hex Bolt All Thread	2
43	CHNSN0533	1/2" Nylock Nut 304 SS	2
44	CHWSF053	1/2 SS flat washer	4
45	CBM220CPG6	2 x 2 Full Port Flange x 6"	1
46	CEWCIM03	16 GA IM Wire Harness-3 toggle switch	1
47	IMSLB01	IMS T-series light kit	1

ICE MASTER® T-SERIES

12 NOZZLE BOOM OVERVIEW

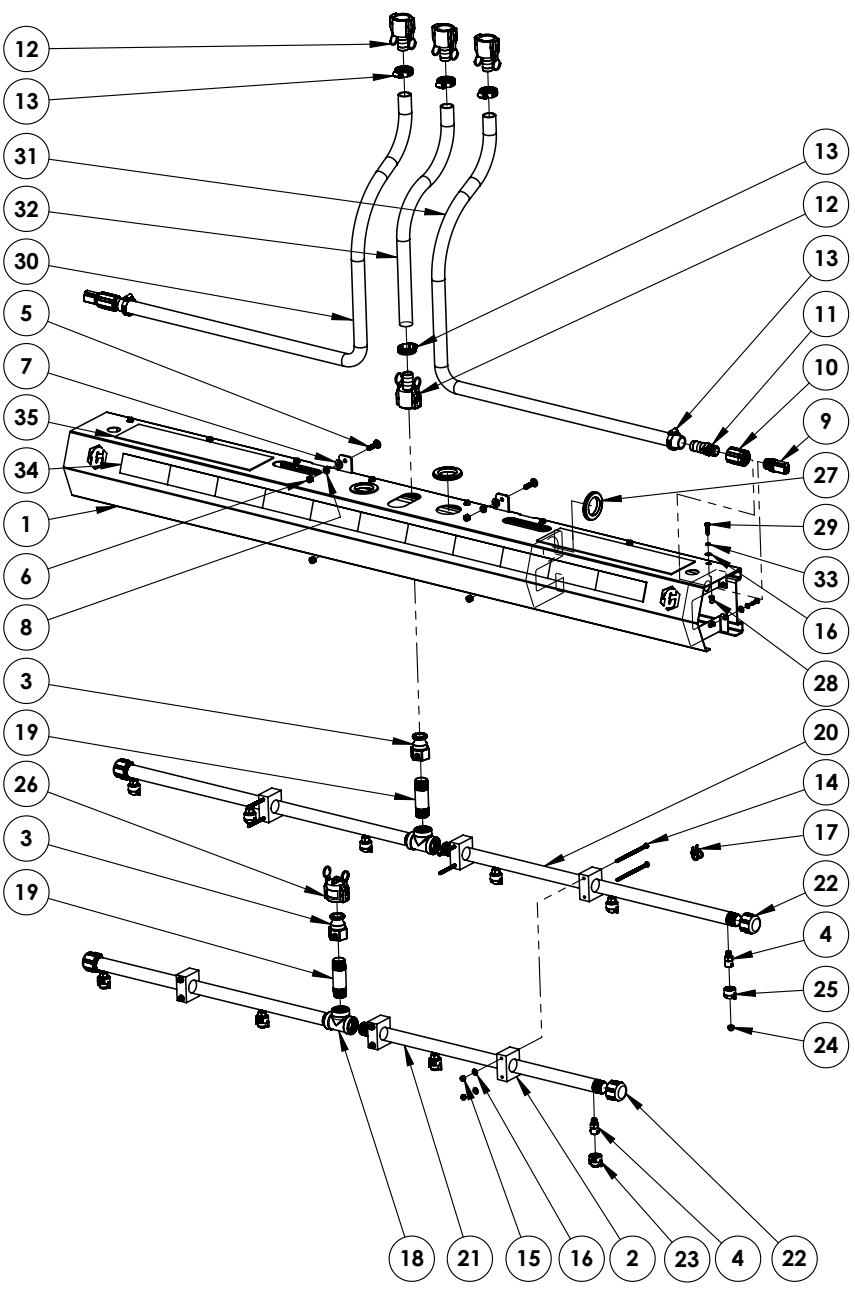

PARTS LIST

ITEM NO.	Part #	DESCRIPTION	QTY.
1	AZFP025	SS Boom Shroud for T-series	1
2	AZFP015	1" Pipe Clamp	6
3	CB100A	1" Male Adapter x 1" FNPT	2
4	CNST017	TeeJet 1/4" NPT x BSPT Female Connection Adapter	10
5	CHBS030723C	3/8" x 1-1/2" SS Carriage Bolt	4
6	CHNSH0323	3/8" SS Hex Nut	4
7	CHWSF033	3/8" SS Flat Washer	4
8	CHWSL033	3/8" SS Lock Washer	4
9	CNSE001	Boom Buster Mod. 370R Spray Nozzle	2
10	CBCPLG075	3/4" Poly Pipe Coupling	2
11	CBHB075100	3/4 MNPT x 1 Hose Shank	2
12	CB100C	1" Female Coupling x 1" Hose Shank	4
13	CFCW003	Clamp For 1" Hose	6
14	CHBS012123	1/4" x 5" Long 18-8 Stainless Hex Head Bolt	6
15	CHNSN0123	1/4" Stainless Lock Nut	6
16	CHWSF013	1/4" SS Flat Washer	23
17	CXSC0002	Cable Tie 8"	2
18	CFST05F304	1" SS Tee	2
19	CFSN05M05M17	1" x 4" Stainless Steel Nipple	2
20	CFSN05M05M360	1 IN x 37 IN Stainless Nipple	2
21	CFSN05M05M30.5	1 IN x 30.5 IN Stainless Nipple	2
22	CBCAP100	1 POLY PIPE CAP	4
23	CNST008	TeeJet Tip-Extended Flat Spray	4
24	CNST025	TeeJet Tip, ST. STL solid stream 1.5GPM	6
25	CNST006	25608 REP. CAP CE Black & Washer	6
26	CB100125CAP	1" & 1.25" Camlock Cap	1
27	CPFG16	2 inch ID Grommet	4
28	CHNSR01218	.25 Stainless Steel Rivet Nut	17
29	CHBS010523	.25 x 1 SS Bolt	17
30	CLUESB020005	1" Hose (To Boomless Nozzle)	1
31	CLUESB020005	1" Hose (To Boomless Nozzle)	1
32	CLUESB020005	1" Hose (Center Boom Hose)	1
33	CHWSL6063	M6 STAINLESS STEEL SPLIT LOCK WASHER GRADE A2	17
34	CTMT003	3M 983 Conspicuity Tape 2 inch x 6 inch Red/6 inch White	7'
35	CTMT007	ANTISLIP TAPE 4 inch	4'

22 NOZZLE BOOM OVERVIEW

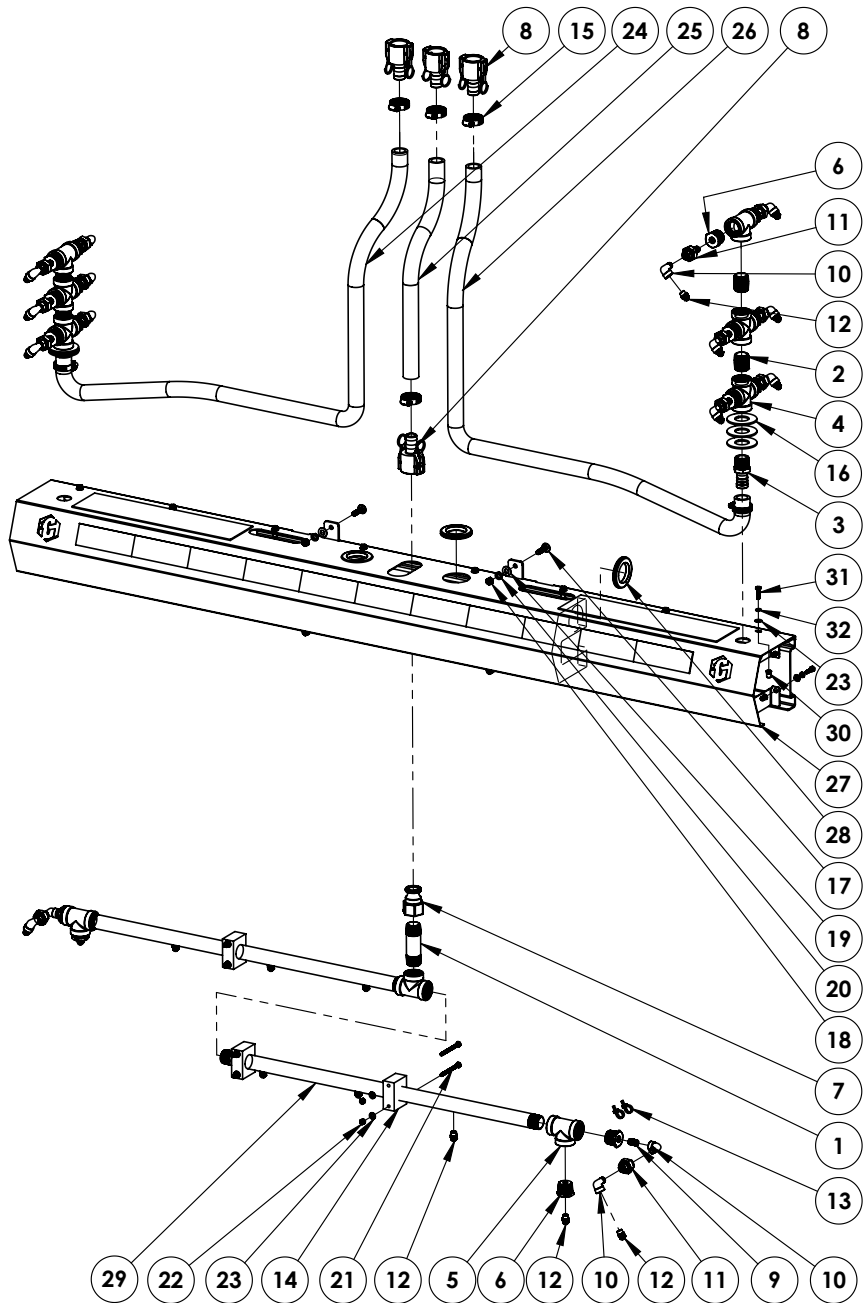

PARTS LIST

ITEM NO.	Part #	DESCRIPTION	QTY.
1	CFSN05M05M17	1" x 4" Stainless Steel Nipple	1
2	CFSN05M05M12	1" x 1-1/2" Stainless Steel Nipple	4
3	CFSS05M05B304	1" MPT x 1" SS Hose Barb	2
4	CFSCR05F304	1" Threaded SS Cross	4
5	CFST05F304	1" SS Tee	5
6	CFSRB05F00M304	1" x 1/4" SS Reducer Bushing	16
7	CB100A	1" Male Adapter x 1" FNPT	1
8	CB100C	1" Female Coupling x 1" Hose Shank	4
9	CFSN00M00M78304	1-4in NPT x 7-8in nipple SS	14
10	CFSE00F00M304	1/4" SS Street Elbow	16
11	CFSU00F00F304	1/4" SS Union	14
12	CNST019	Teejet Tip ST. STL solid stream MPT 6 GPM	22
13	CXSC0002	Cable Tie 8"	2
14	AZFPM015	1" Pipe Clamp	3
15	CFCW003	Clamp For 1" Hose	6
16	CHWSF123	1.25 Stainless Washer	6
17	CHBS030723C	3/8" x 1-1/2" SS Carriage Bolt	4
18	CHNSH0323	3/8" SS Hex Nut	4
19	CHWSF033	3/8" SS Flat Washer	4
20	CHWSL033	3/8" SS Lock Washer	4
21	CHBS011323	.25 x 3 IN 18-8 Stainless Hex Head Bolt	6
22	CHNSN0123	1/4" Stainless Lock Nut	6
23	CHWSF013	1/4" SS Flat Washer	23
24	CLUESB020005	1" Hose (To Driver Side Nozzles)	1
25	CLUESB020005	1" Hose (Center Boom Hose)	1
26	CLUESB020005	1" Hose (To Passenger Side Nozzles)	1
27	AZFPM025	SS Boom Shroud for T-series	1
28	CPFG16	2 inch ID Grommet	4
29	CFSN05M05M34	1 IN x 34 IN Nipple 304 SS	2
30	CHNSR01218	.25 Stainless Steel Rivet Nut	17
31	CHBS010523	.25 x 1 SS Bolt	17
32	CHWSL6063	M6 STAINLESS STEEL SPLIT LOCK WASHER GRADE A2	17
33	CTMT003	3M 983 Conspicuity Tape 2 inch x 6 inch Red/6 inch White	7'
34	CTMT007	ANTISLIP TAPE 4 inch	4'

DEICING HOSE REEL

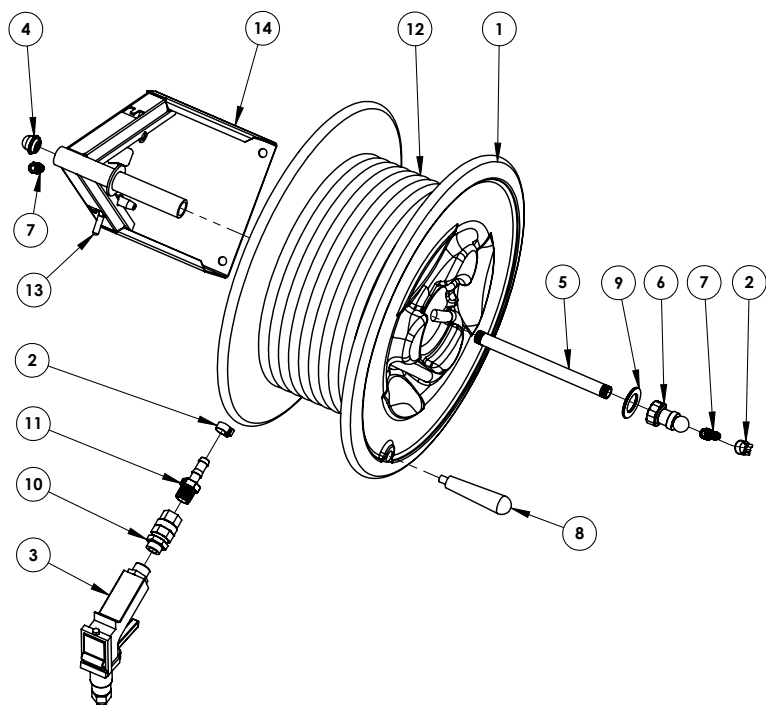

PARTS LIST

ITEM NO.	PART #	DESCRIPTION	QTY.
1	AMAH01GY	HR030/050 REEL ONLY	1
2	CFCC003	Clamp for 1/2" Hose	2
3	CPLF01	Heavy Duty Spray Gun STAL16-viton seals	1
4	CFRB06	1/4-3/8 BSP FEMALE ELBOW	1
5	CFRB07	STAINLESS PIPE 3/8 THREAD BOTH ENDS	1
6	CFRB08	3/8 X 1/4 BALL BEARING SWIVEL	1
7	CFRB09	1/4 MALE THREAD X 1/2 HOSE BARB	2
8	CFRH03C	PHENOIC TAPERED HANDLE	1
9	CHWZF105	1 SAE Flat Washer	1
10	CFBW04M04FB	.5 M BSP - .5 F NPT Heavy Duty Swivel	1
11	CFPS02M02B	1/2 MNPT x 1/2 Hose Barb	1
12	CLUESB020002	1/2 EPDM HOSE - 50"	1
13	AZKH0018	Lock for Small Hose Reel	1
14	AZKH0003SS	3ASR03B HR FRAME 304 SS	1

LIGHT KIT

ITEM NO.	Part #	DESCRIPTION	QTY.
1	AZKF0020	3 bank electric valve light bracket	1
2	CEWCIM05	Light Wire Harness IMS	1
3	CHNSN903	10-32 18-8 SS LOCKNUT	2
4	CHMS900213	10-32 - 1/2 Pan head screw	2
5	CHNSN0223	5-16 SS Nyloc Nut	2
6	CHWSF023	5/16" SS Flat Washer	4
7	CHBS020323	5-16 x .75 SS Bolt	2

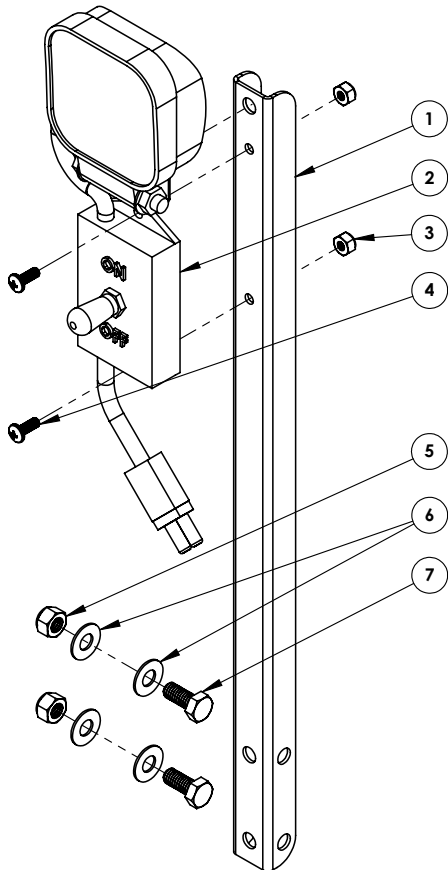
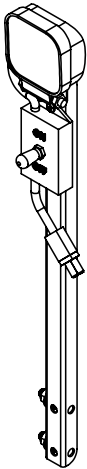

ADJUSTABLE RECEIVER HITCH

ICE MASTER® T-SERIES

ITEM NO.	Part #	DESCRIPTION	QTY.
1	AZKI017	Adj Rec hitch U - Bracket	1
2	AZKI018	Adj Rec Hitch Tube	1
3	CHBS030523	3-8" x 1" SS Hex Bolt	4
4	CHWSF033	3/8 SS Flat washer	8
5	CHWSL033	3/8" SS Lock Washer	4
6	CHNSN0323	3/8" SS Nylock Nut	2
7	CHBS031523	3/8-16 X 3-1/2 SS ALL THREAD BOLTS	2

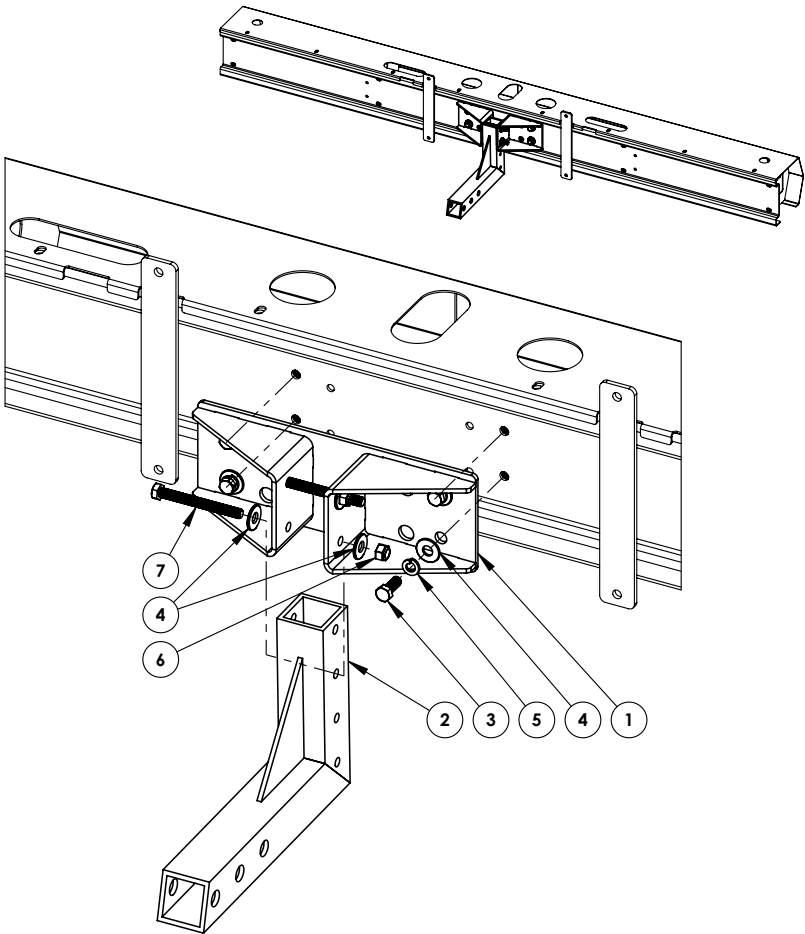

1. Attach item #1 to the back of boom shroud using qty four item #'s 3, 5, & 4.
(there is a weld nut on the inside of the shroud to fasten into)
2. Attach item #2 into item #1 in your desired height setting using item #'s 7, 4, & 6.
Tighten up bolts securely.

ADJUSTABLE BOOM BRACKET

ITEM NO.	Part #	DESCRIPTION	QTY.
1	AZKB0005SS	23.75" Stainless Steel Adj. Boom Bracket	2
2	CHNSN0323	3/8" SS Nylock Nut	4
3	CHWSF033	3/8" SS Flat Washer	8
4	CHBS030523	3-8" x 1" SS Hex Bolt	4
5	CHWNR03	Self retaining washer for 3/8 and M9	4

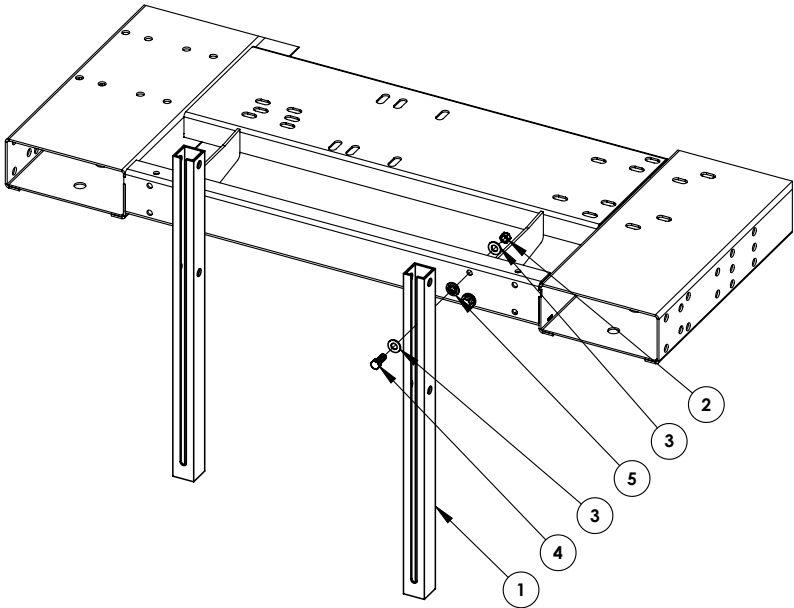
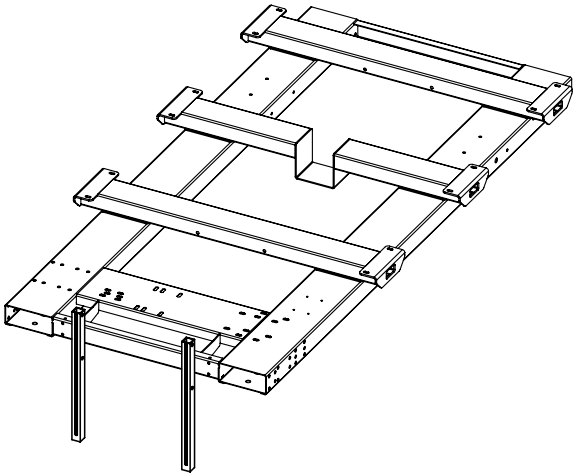

24" FOLDING BOOM BRACKET

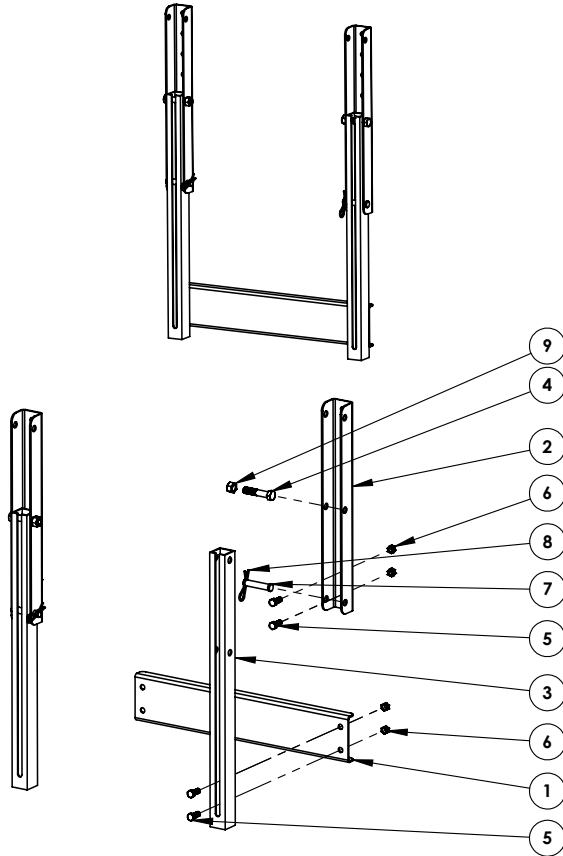

ITEM NO.	Part #	DESCRIPTION	QTY.
1	CSLC461	Cross Support for Folding Boom tubes	1
2	CSLC462	Adj Folding Boom Fstng Bracket	2
3	AZKB0005SS	23.75" Stainless Steel Adj. Boom Bracket	2
4	CHBS051123	2.5 IN x .5 IN Stainless bolt	2
5	CHBS030523	3-8" x 1" SS Hex Bolt	8
6	CHNSN0323	3/8" SS Nylock Nut	8
7	CHCS0509618	Clevis Pin .5 IN Dia x 2 IN Length Stainless	2
8	CHCZ0009	3-32 x 1 IN cotter pin Stainless	2
9	CHNSN0533	1/2" Nylock Nut 304 SS	2

38" FOLDING BOOM BRACKET

ICE MASTER® T-SERIES

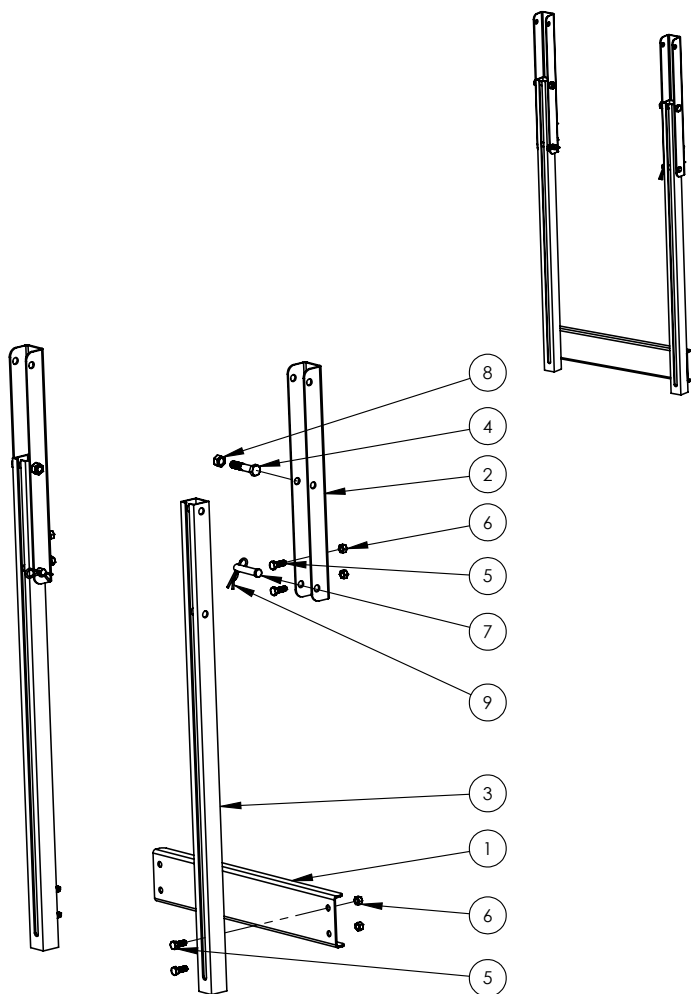

ITEM NO.	Part #	DESCRIPTION	QTY.
1	CSLC461	Cross Support for Folding Boom tubes	1
2	CSLC462	Adj Folding Boom Fstng Bracket	2
3	AZKB0006SS	38 Adjustable Boom Bracket	2
4	CHBS051123	2.5 IN x .5 IN Stainless bolt	2
5	CHBS030523	3-8" x 1" SS Hex Bolt	8
6	CHNSN0323	3/8" SS Nylock Nut	8
7	CHCS0509618	Clevis Pin .5 IN Dia x 2 IN Length Stainless	2
8	CHNSN0533	1/2" Nylock Nut 304 SS	2
9	CHCZ0009	3-32 x 1 IN coffer pin Stainless	2

STORAGE STAND

ITEM NO.	Part #	DESCRIPTION	QTY.
1	AZKI001	IMS Leg Stand Sleeve	4
2	AZKI002	IMS Leg Stand Leg	4
3	CV722HP	5/8 x 3 Bent Hitch Pin	4
4	CHAS050723	1/2" x 1-1/2" Stainless Hex Bolt All Thread	16
5	CHNSN0533	1/2 Nylock Nut 304 SS	16

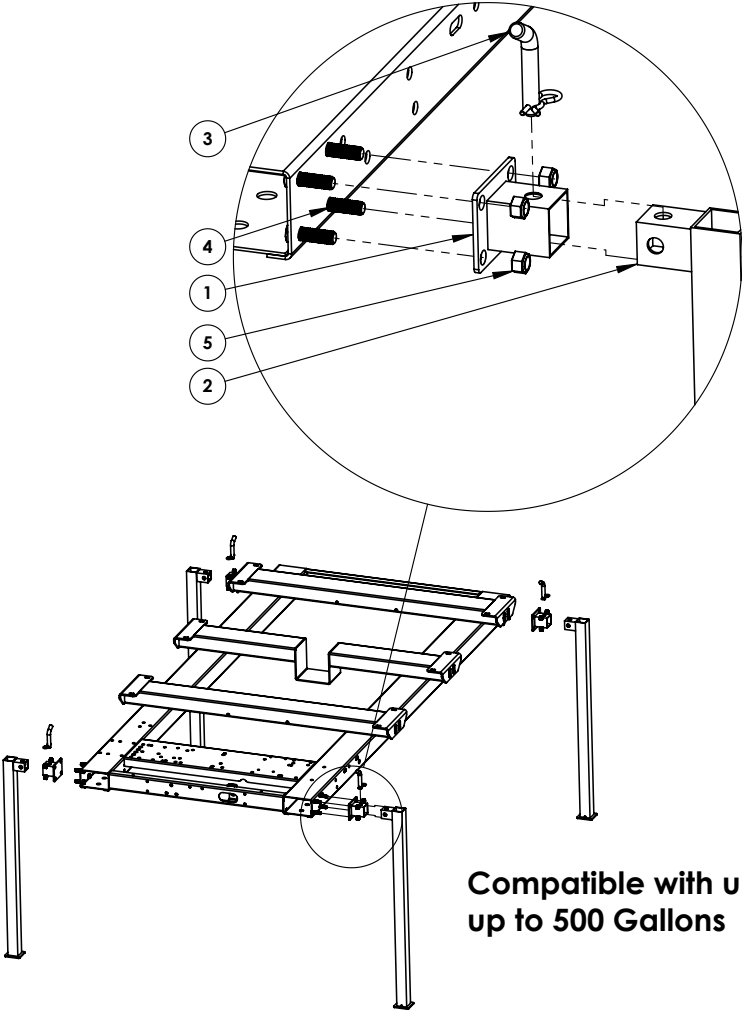

Compatible with units
up to 500 Gallons

SELF-LOADING LEGSTAND

ITEM NO.	Part #	DESCRIPTION	QTY.
1	AZKI003	Front Leg Bracket	2
2	AZKI004	Front upper leg	2
3	AZKI005	Rear Bracket	1
4	AZKI006	Bottom Leg	2
5	AZKI019	Rear Adj Leg	2
6	AZKIR001	Roller wheel for IMSLS02 Folding Leg Kit	2
7	CV722HP	5/8 x 3 Bent Hitch Pin	6
8	CV712HP	.75 IN x 4.25 IN snap Lock Hitch Pin	2
9	CHAS050723	1/2" x 1-1/2" Stainless Hex Bolt All Thread	16
10	CHNSN0533	1/2" Nylock Nut 304 SS	16
11	CHBZ089525	.75inch 10.5 inch zinc plated bolt	2
12	CHBS0821218	3/4" x 5" SS bolt	2
13	CHNSN08218	3/4" SS NYLON LOCK NUT 18-8(304)	4

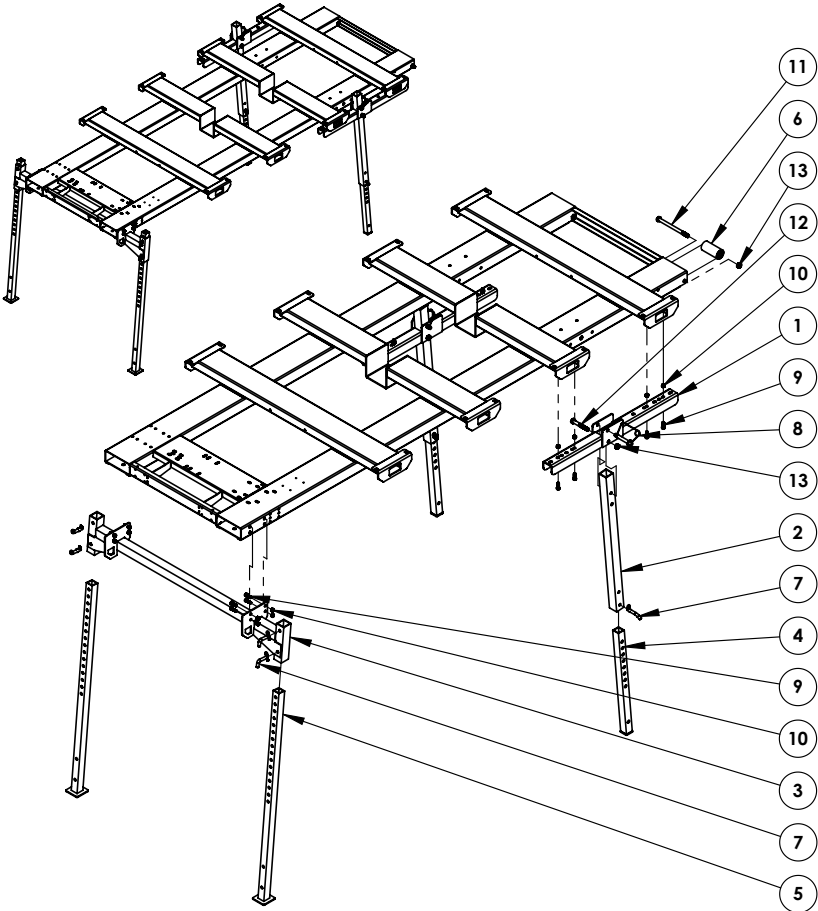

HEAVY DUTY SELF- LOADING LEGSTAND

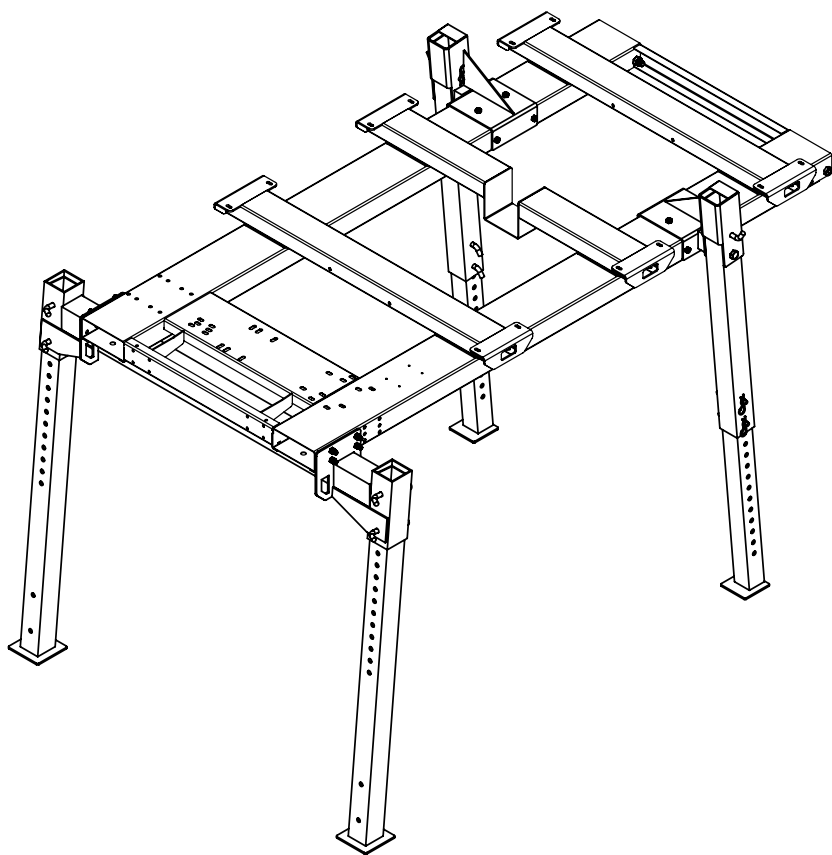

ICE MASTER® T-SERIES

Compatible with Frames 500 and larger

HEAVY DUTY SELF-LOADING LEGSTAND

ICE MASTER® T-SERIES

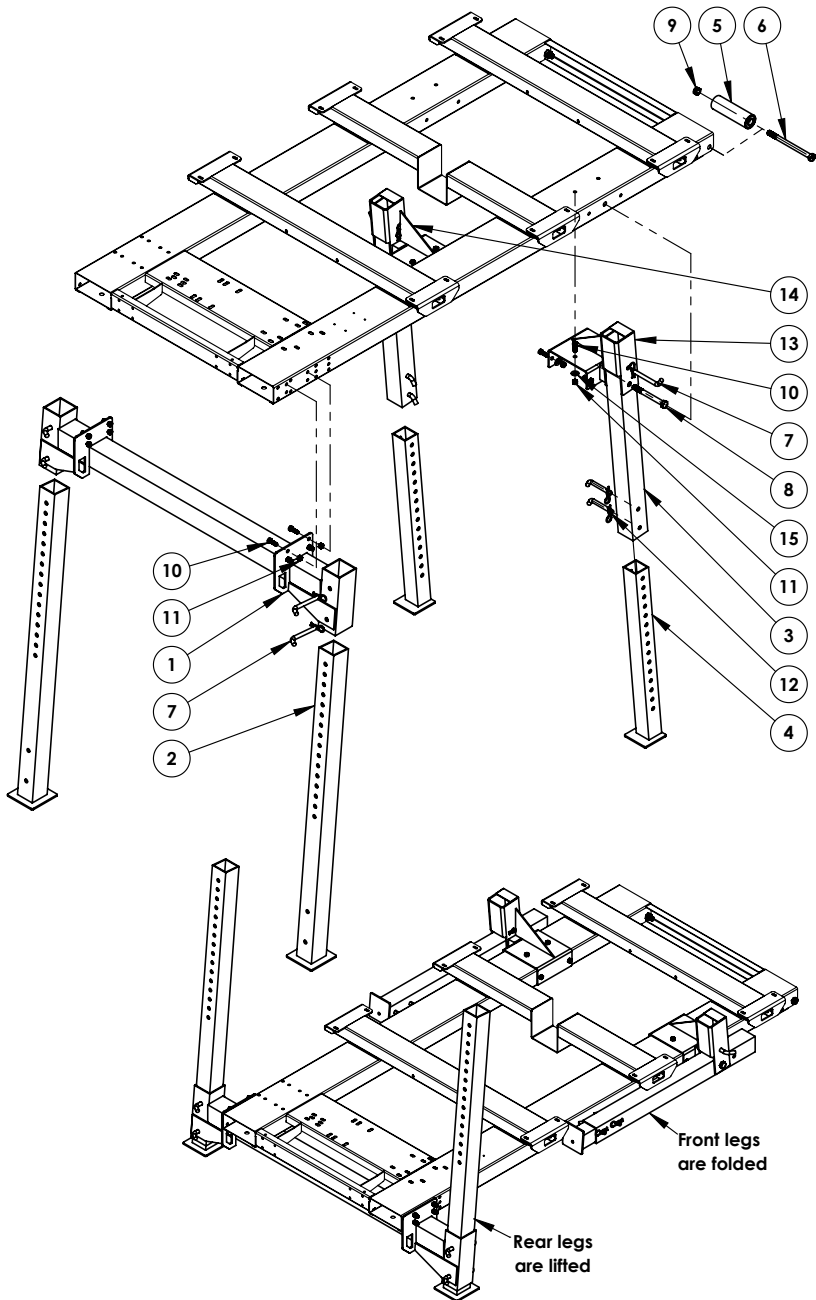

PARTS LIST

ITEM NO.	Part #	DESCRIPTION	QTY.
1	AZKI022	IMS Rear Leg Bracket for 4 IN Kit	1
2	AZKI025	IMS Rear Adj Leg for 4 IN Kit	2
3	AZKI024	IMS Front Upper Leg for 4 IN Kit	2
4	AZKI023	IMS Front Adj Leg for 4 IN Kit	2
5	AZKIR001	Roller wheel for IMSLS02 Folding Leg Kit	2
6	CHBZ089525	.75inch 10.5 inch zinc plated bolt	2
7	CHCS0621618	5-8 x 5 Bent Hitch Pin	6
8	CHBS0829218	.75inch 7 inch SS bolt	2
9	CHNSN08218	3/4" SS NYLON LOCK NUT 18-8(304)	4
10	CHAS050723	1/2" x 1-1/2" Stainless Hex Bolt All Thread	20
11	CHNSN0533	1/2" Nylock Nut 304 SS	20
12	CHCS0617618	SS Bent-Pull Clevis Pin, 5/8" x 4 inch	4
13	AZKI026	IMS Folding Leg PS Front Brkt 4 IN Kit	1
14	AZKI027	IMS Folding Leg DS Front Brkt 4 IN Kit	1
15	CHWSF053	1/2 SS flat washer	12

HOSE REEL BRACKET RISER

ITEM NO.	PART #	DESCRIPTION	QTY.
1	CHNSN0323	3/8" SS Nylock Nut	8
2	CHWSF033	3/8 SS Flat washer	16
3	CHBS030523	3-8" x 1" SS Hex Bolt	8
4	AZKH0020	Hose Reel Bracket Riser	1

ICE MASTER® T-SERIES

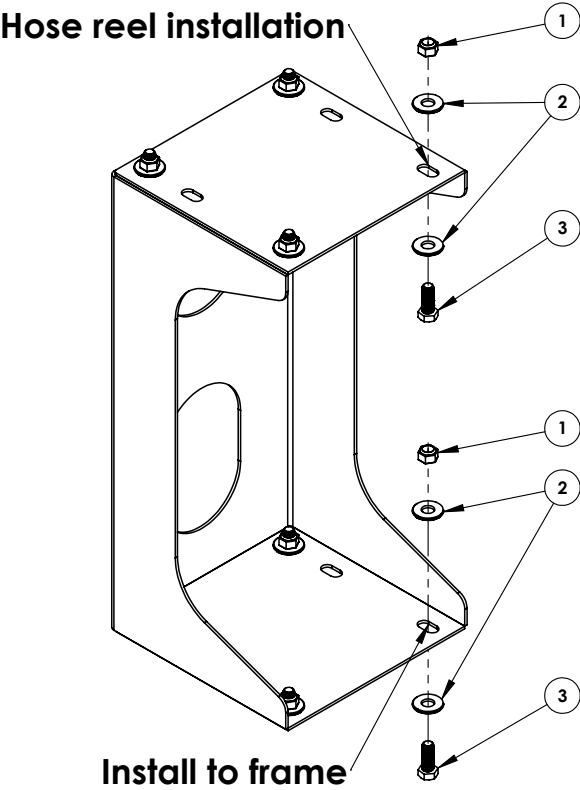

HITCH PIN BRACKET ASSEMBLY

ITEM NO.	Part #	DESCRIPTION	QTY.
1	CHBS050723	.5 x 1.5 IN 18-8 Stainless Hex Head Bolt	8
2	CHWSF053	1/2 SS flat washer	8
3	CHNSN0533	1/2" Nylock Nut 304 SS	8
4	AZKI008	Tail Gate Locking Pin Bracket Stainless Steel L&R Set	1

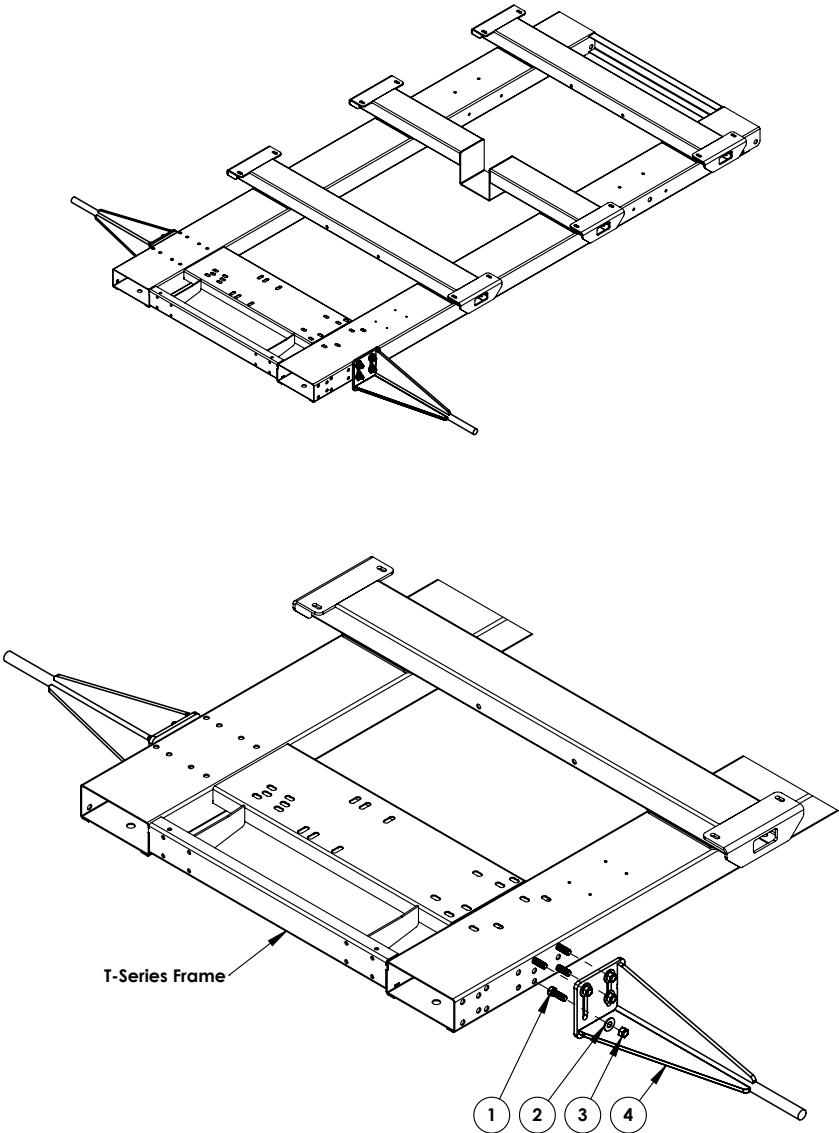

STORM COMMANDER HARNESS **COMPONENTS**

ITEM NO.	PART #	DESCRIPTION	QTY.
1	CEC063	SC InCab Ctrl	1
2	CEC064	SC Pwr Cord InCab Ctrl	1
3	CEC066	SC Pwr Cord Receiver	1
4	CEC067	SC Pwr Cable 3 Sec Boom	1
5	CEC068	SC Ctrl Cable FM-Valve	1
6	CEC069	SC Ctrl Cable Aux Pwr Split	1
7	CEC070	SC Aux Pwr Cable WP Plug	1

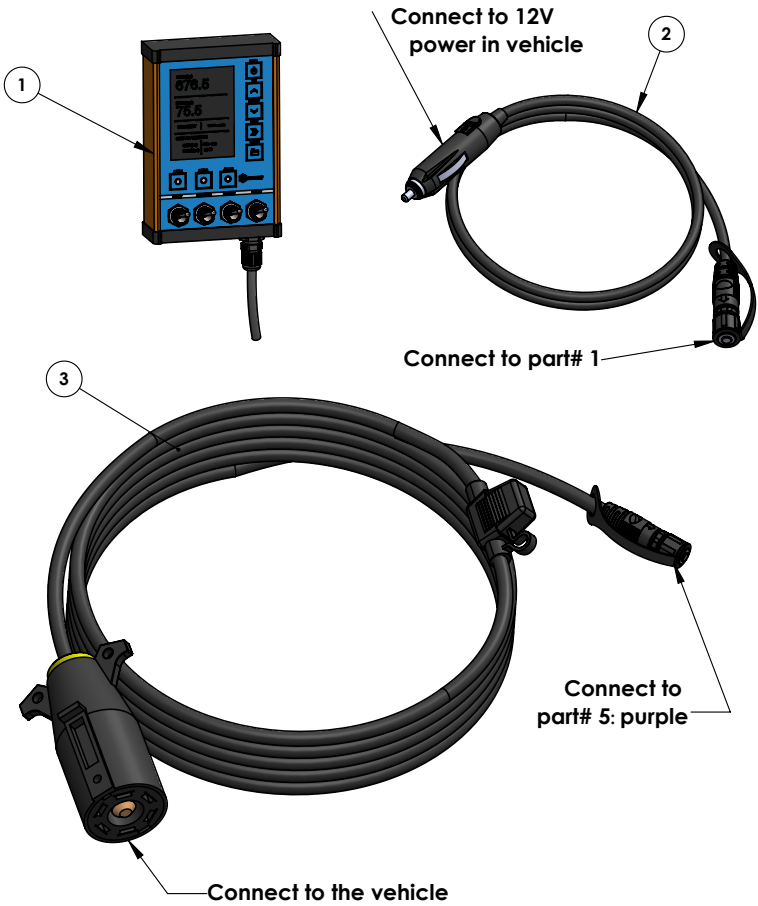

STORM COMMANDER HARNESS COMPONENTS

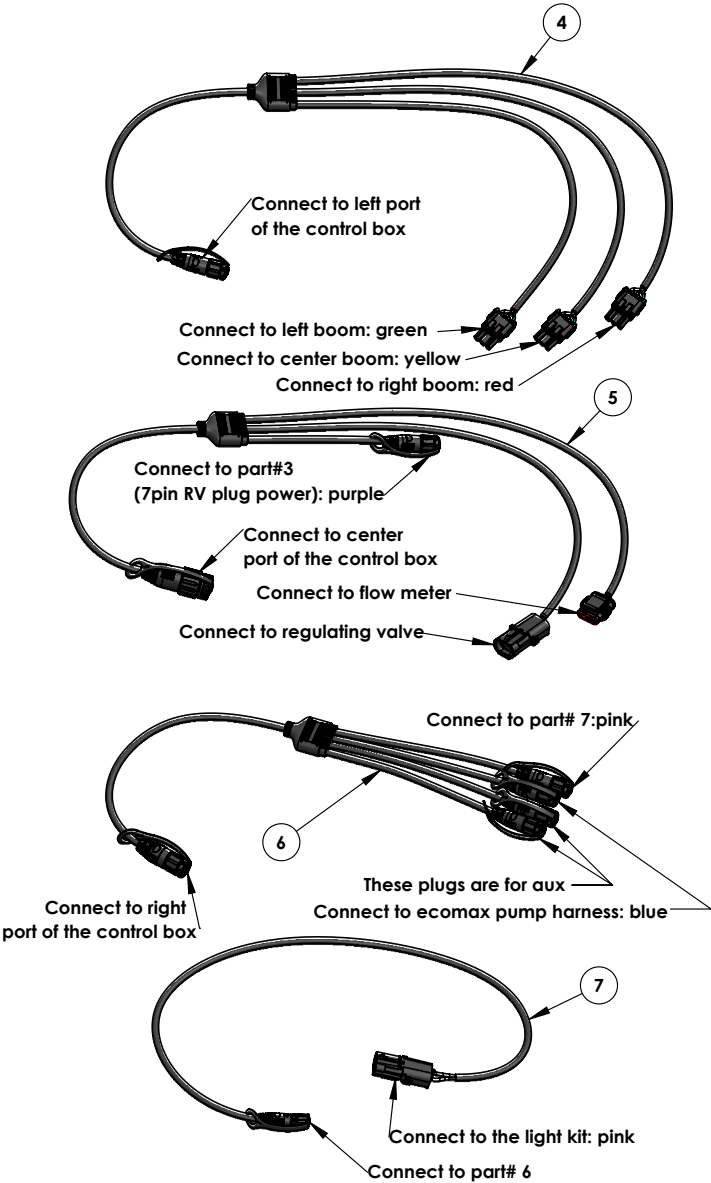

WARRANTY

CAMION® LIMITED WARRANTY:

Camion®, a division of Enduraplas, LLC ("Camion®") agrees to provide this non-transferable, non-assignable limited warranty ("Limited Warranty") to the original end-user purchaser ("Buyer") only of registered Camion® products ("Camion® Products") pursuant to the terms and conditions provided herein. By accepting delivery of Camion® Products the Buyer likewise agrees to the written terms and conditions of this Limited Warranty. This Limited Warranty give the Buyer specific legal rights and the Buyer may have other rights that vary from state to state.

A. LIMITED WARRANTY COVERAGE

Camion® Products Complete Product Limited Warranty - Subject to the terms and conditions of this Limited Warranty, Camion® warrants to the Buyer of Camion® Products that it will be free from defects in workmanship for a period of one (1) Year after the date of the original purchase. At it's sole option, Camion® will repair or replace defective parts at no charge for parts and labor.

Camion® Products Proprietary Parts and Frames Limited Warranty - Notwithstanding the foregoing and subject to the terms and conditions of this Limited Warranty, Camion® warrants to the Buyer of Camion® Products that the parts and frames will be free from material defects in materials and workmanship for a period of one (1) Year after the date of original purchase. At its sole option, Camion® will repair or replace defective parts at no charge for parts, but labor shall be the responsibility of the Buyer.

Third Party Parts and Components - This Limited Warranty does not cover certain third party manufactured parts and components, as such parts and components are covered by separate limited warranties provided by such third party manufacturers. For information regarding said limited warranties, please see each individual third party limited warranty.

Camion® Products Polyethylene Tank Limited Warranty - This Limited Warranty does not cover Camion® Products Polyethylene Tanks(s), as such materials are covered by a separate limited warranty provided by Enduraplas®, LLC. For Information regarding said limited warranty, please see the Enduraplas® Limited Warranty.

B. WHAT THIS LIMITED WARRANTY DOES NOT COVER

Camion® does not provide any warranty coverage, not have any liability or responsibility for any defects, costs, expenses, or damages relating to any of the following:

- Expendable parts, such as nuts, bolts, etc. or any parts not furnished by Camion® or any damage caused by such parts.
- Airborne chemicals, road debris, salt, hail, floods, fire, windstorms, lightning or other acts of nature and other environmental conditions.
- Water contamination.
- Any part or product installed, repaired, or altered by anyone other than a Camion® Products authorized dealer or any damage caused by such parts or products.
- Normal maintenance services.
- Incidental or consequential damages, including but not limited to inconvenience, transportation, person injury, loss of property or loss of revenue.
- Parts or products that have been subject to abuse, negligence, accident, theft, tampering, misuse, neglect, corrosion, mishandling, improper maintenance, lack of or improper maintenance, care or storage.

WARRANTY

Installation of Camion® Products to a vehicle, including modification of Camion® Products or any such vehicle, is entirely at the Buyer's risk and expense, and compliance with motor vehicle regulations is the responsibility of the Buyer. Camion® is not responsible for any damage whatsoever to vehicles caused by installation or use of Camion® Products equipment.

Camion® Products are not intended for personal, family or household use and, as such, this Limited Warranty does not cover such use.

C. OTHER WARRANTIES DISCLAIMED AND EXCLUDED

THERE ARE NO WARRANTIES, EXPRESS OR IMPLIED, WHICH EXTEND BEYOND THE LIMITED WARRANTY HEREIN STATED, AND EXCEPT TO THE EXTENT PROHIBITED BY APPLICABLE LAW, CAMION® EXPRESSLY DISCLAIMS AND EXCLUDES ANY AND ALL OTHER WARRANTIES INCLUDING BUT NOT LIMITED TO WARRANTIES OF MERCHANTABILITY, FITNESS FOR PARTICULAR PURPOSE, INFRINGEMENT, CUSTOM OR USAGE OF TRADE, AND COURSE OF DEALING. NO AGENT, EMPLOYEE OR REPRESENTATIVE OF CAMION HAS AUTHORITY TO BIND CAMION® TO ANY REPRESENTATION OR WARRANTY EXCEPT AS STATED IN THIS LIMITED WARRANTY.

D. PROCEDURE FOR OBTAINING WARRANTY COVERAGE

To submit a Limited Warranty claim, the Buyer must notify Camion® of the claimed defect within ten (10) days that the defect becomes known, in writing, at: cs@camionsystems.com. The original invoice or other similar proof of purchase of the applicable product or part must be provided by the Buyer to Camion® when making a claim under this Limited Warranty. Warranty claims must be received in writing by Camion® within the Limited Warranty period. To obtain service pursuant to this Limited Warranty, the Buyer must return the defective product or part to any Camion® Products authorized dealer (preferably, the dealer from whom the product or part was purchased). The Buyer shall be responsible for all transportation expenses to and from said dealer and accepts all risk of any damage in transit. To locate the nearest Camion® Products authorized dealer, please see the dealer locator at www.camionsystems.com.

The Limited Warranty is given solely to the Buyer and may not be transferred or assigned to any other person.

If you have questions about this Limited Warranty, contact Camion® at: cs@camionsystems.com.

E. GOVERNING LAW

This Limited Warranty will be governed by the laws of the State of North Dakota, without giving effect to any choice of law rule that would cause the application of the laws to any other jurisdiction. Any disputes regarding matters relating to the Limited Warranty will be resolved exclusively in the State of North Dakota and all parties consent to such jurisdiction. RIGHTS TO A JURY TRIAL, CLASS ACTION AND CONSOLIDATED DISPUTE RESOLUTIONS PROCEEDINGS ARE HEREBY WAIVED TO THE FURTHEST EXTENT PERMITTED BY LAW.

F. DISCLAIMER OF EXPENSES AND DAMAGES

The performance of necessary repairs and replacements, as determined by Camion® in its discretion, is the sole and exclusive remedy under this Limited Warranty or any implied warranty. Camion® does not authorize any person, including Camion® Products authorized dealers, to create for it any other obligation or liability in connection with Camion® Products. Except to the extent prohibited by applicable law, Camion® shall not be liable for personal injury, property damage, loss of liquid, loss of profit, incidental, consequential, contingent or special damages, or any other damages resulting from the use of, or inability to use, Camion® products whether based on breach of this written Limited Warranty or any implied, breach of contract, negligence or strict liability.

ACTIVATE YOUR 10-YEAR WARRANTY

How to Activate

To double your 5-year tank warranty,
visit www.camionsystems.com/warranty/
and register this product.



Watch Instruction Videos:
www.youtube.com

Discover More Helpful Tips:
www.iceControlTraining.com



CAMION®

by Enduraplas

1 (877) 265-9929

cs@camionsystems.com

www.camionsystems.com

113 1st Street, Neche
ND 58265, USA

Discover More Helpful Tips:

www.IceControlTraining.com